

CANARA BANK, GA SECTION, CIRCLE OFFICE, HYDERABAD

From:

G A SECTION, Telephone: 040-27725221
 Circle Office, Canara Bank,040-27725223
 #10-3-163 & 10-3-163/A.
 Plot No.85, Beside Rail Nilayam,
 Secunderabad -500026
 E-mail: pecohyd@canarabank.com

Date: 06.12.2024

Notice Inviting Tender

WORK: Electrical and AC works at Somajiguda I Branch

| | |
|--|--|
| Location of the Branch/Office | Somajiguda I |
| Last date for submission of quotation | 17.12.2024 up to 3:00 pm |
| Date & Time of opening quotation | 17.12.2024 up to 4:00 pm |
| Estimation of cost | Rs.11.10 lakhs |
| Time limit for execution of work | 21 days from the date of work order |
| Defect liability period | 12 months after completion of work |
| Retention money towards defect liability period | 5 % of actual bill |
| Date of commencement of work | As per work order |
| Income Tax &/ other taxes | At applicable rate |
| Payment | After the completion of the work, as per procedure |
| Period for submitting final bill by contractor | Within one month from the date of virtual completion of the work |
| Liquidated damage for non completion of work in time | 1%(one per cent) of the Contract Value per week or part there off of delay subject to a limit of 10%(ten percent) of the Contract Value as "Liquidated damages" for the period during which the said works shall so remain incomplete or the Employer may deduct aforesaid sum towards such damages from any monies due to the Contractor. |
| Insurance | At contractor's cost |
| Validity of submitted tender | 60 days from the opening of tenders |

Sealed tenders are invited on behalf of Canara Bank for the above mentioned work. The Bill of quantities, terms and conditions& layout are enclosed. **THE WORK IS TO BE**

SIGNATURE OF THE TENDERER



CANARA BANK, GA SECTION, CIRCLE OFFICE, HYDERABAD

EXECUTED IN A TIME BOUND MANNER. HENCE YOU ARE ADVISED TO PARTICIPATE IN THE TENDER ONLY IF YOU ARE WILLING TO START THE WORK IMMEDIATELY AND COMPLETE IT WITHIN 21 DAYS TIME FROM THE DATE OF WORK ORDER. SITE IS READY FOR IMMEDIATE UNDERTAKING OF THE TENDER WORKS. The sealed tender must be dropped in tender box kept at the Circle Office within the above stipulated time. The tenders shall be opened at our office at the above specified time. The tenderers' authorized representatives are requested to be present at the time of opening. Canara Bank will not be bound to accept the lowest tender & reserves the right to reject any or all the tenders without assigning any reason thereof.

Place: Hyderabad
Date: 11.12.2024

Sd/-

Assistant General Manager
G A SECTION
CO: Hyderabad

SIGNATURE OF THE TENDERER



CANARA BANK, GA SECTION, CIRCLE OFFICE, HYDERABAD

To

The Assistant General Manager,
P & E Section,
Canara Bank Circle Office,
Hyderabad - 500026.

Dear Sir,

Sub: Electrical & AC works in the premises of **Somajiguda I BRANCH**

I/We hereby declare that I/ We have carefully gone through the conditions laid down in the Notice Inviting Tender, General notes, General Conditions of Contract, Special conditions, Schedule of approximate quantities and rates, Form of Agreement, General Specification, Approved manufacturers/natural source of materials Technical Specifications of schedule of quantities, and clearly understood all the same and on the basis of the same I/ We have quoted our rates in the Schedule of Quantities(i.e. BOQ) attached with the tender documents.

In the event of this Tender being accepted I/ We agree to enter into the agreement and submit the declaration on requisite non-judicial stamp papers as and when required and execute the contract according to your form of Agreement etc., in default whereof, I/ We do hereby bind my-self / ourselves to forfeit the aforesaid deposit.

I / We further agree to complete the work included in the said schedule of quantities within specified time from the date of the work order issued to commence the same.

I / We agree to pay all taxes(except GST), insurance charges as prevailing from time to time, on such items for whom same is to be levied by/ for the government, and the rates quoted by me / us are inclusive of all the same.

Once again knowing fully well the contents of this tender, I / We sign this tender on this _____ Day of _____ month of 2024.

SIGNATURE OF THE TENDERER



CANARA BANK, GA SECTION, CIRCLE OFFICE, HYDERABAD

SPECIAL CONDITIONS & INSTRUCTIONS FOR THE GUIDANCE OF TENDERER

1. The works at the branch/Office premises need to be executed duly taking care of the local bye laws/regulations of the local authorities like Police Dept, Water supply and Sanitary Board, Electricity Board, Central/ State Labor Commission etc. Necessary permissions, licenses, temporary connections if needed shall be obtained by the Contractor and Bank shall not be held responsible for any lapses.
2. The works shall be executed duly taking care of all safety measures and Bank shall be fully indemnified for any 3rd party claims, casualties, mishaps, loss of property etc. related to the undertaking & the execution of the subject work.
3. **GST TAXES:** As per the new Goods & Services Tax (GST) structure, the tenderers are required to have GSTIN number & Tenderers without GSTIN number are not eligible to participate in the tender process. The details as per the Annexure I attached are to be mandatorily furnished along with the tender. The eligible tenderers are requested to quote the GST separately. The taxes will be deducted at source as per the statutory requirements. While raising the bill, it shall be mentioned as bill to Canara Bank and our Bank's GSTIN number to be mentioned.
4. CANARA BANK'S TELANGANA STATE GSTIN NUMBER is 36AAACC6106G3Z0.
5. Tenderers are requested to submit the EMD in the form of crossed Demand draft only on any of the nationalized Banks/State Bank Drawn in favor of Premises & Estate Section, Circle Office, Canara Bank, Hubballi, payable at Hubballi. Tender with EMD in any other forms shall be rejected.
6. Tenderers are expected to visit the site before quoting the rates and should satisfy themselves as to the nature and conditions of work facilities available etc.
7. The tenderers are required to examine the enclosed general plan, tender form and conditions mentioned in the tender.
8. The tenderers should quote the rates in the figures. The amount for each item should be worked out and the requisite totals shall be given. The total amount shall be written both in figures and words.
9. The rates quoted in the tender shall be for measured finished works and shall include all changes including cost of materials, transportation, freight charges etc. complete.
10. The work is to be completed within stipulated time.
11. The successful tenderers shall give all necessary personal attention to the work during the process of work and also until the expiry date of "Defects Liability Periods" which is **12 months** after the date of completion of the work.
12. The bank reserves the right to reject any portion of the work or material, which is, found unsatisfactory not up to the standard.
13. A retention amount of **5% of the bill amount** will be retained from the final bill and shall be paid to the successful tenderers after the defects liability period is over and upon the certification of the engineer.

CANARA BANK, GA SECTION, CIRCLE OFFICE, HYDERABAD

14. Income tax deduction at prevailing / appropriate rates will be retained from each running bill which will be certified by the income tax authorities and a receipt will be given to the contractors.

CONDITIONS OF CONTRACT

1. If any additions and alterations are found necessary, the tenderers will have to do the same within the tendered rates with the prior approval of the bank.
2. The contractor shall employ adequate labor to complete the work within the scheduled time and shall make his own arrangements for housing his materials etc.
3. The contractor shall have to make his own arrangements to house his labor and staff for their services.
4. All tendered rates shall include for the cost of materials, labor, supervision, tools, plant, transportation, contingencies, duties, breakages, wastages, sundries, scaffolding, etc complete.
5. All instruction regarding the execution of the work shall be received from the officials through consultant/architect only. Any other instructions issued directly to the contractor by anyone else shall not be binding on the bank.
6. The bank shall have the power to omit or cancel any item of work without assigning any reason whatsoever and no claim for compensation for damage will be entertained for such omissions and cancellation.
7. The contractor shall maintain satisfactory progress of work as well as maintain a desired level of workmanship. If in the opinion of the bank the progress is unsatisfactory and / or the workmanship is unsatisfactory then the bank shall take possession of the work **within 7 days** to that effect. The bank shall then complete the entire work and rectify all the defects at the contractor's cost and consequences.
8. In case the bank is not satisfied with the quality of materials used by the contractors, they reserve the right to direct the contractor to procure such materials supplied from agencies they deem fit.
9. The contractor is to be responsible for clearing any, all dirt and rubbish and superfluous materials as they accumulate and everything unnecessary and to leave the premises in a clean and orderly condition on completion and fit for occupation. No extra payment shall be made for doing this.
10. Any work which is not approved by the bank shall have to be removed within 24 hours from the time of order and shall have to be redone by the contractor at his own cost and this cost will be borne by the contractor.
11. No deviation whatsoever for any reason will be permitted, however, if any deviation becomes necessary, the same should be brought to the immediate notice of the bank and written approval must be obtained for such deviation before proceeding with the execution of work.
12. The bank has got the right to supply any materials required for the work and cost of materials so supplied will be deducted from the bills of the successful contractor.
13. The contractor shall be responsible for safe custody of his materials/materials issued to him by the bank till they are used for the work. He shall make his own arrangements for the safe custody and proper storage and preservation in sound condition till the same are actually used in the work.



CANARA BANK, GA SECTION, CIRCLE OFFICE, HYDERABAD

14. The tenderers shall extended full co-operation to the other contactor /agencies like electrical, air conditioning, Fire & CCTV, LAN etc who are also working for the same project and co-ordinate with them in finishing the awarded work within the stipulated time given.
15. The contactor shall have a competent supervisor on the site for all the time.
16. For any new item the rate will be fixed by the bank as per prevailing fair market rate and labor which will be binding on the contactor.
17. In case the brand of materials mentioned in the tender is not available in the market, the alternate brand shall be used only after prior written approval of the bank.
18. The contactor shall be given a single electrical connection at work site. Electrical charges for consumption by the contactor will be charged separately by the bank, contractors have to provide sub-meter.
19. The successful tenderers shall not anticipate any financial help from the bank in the form of adhoc payment / advance for mobilizing and for starting the work.
20. The contractor should strictly adhere to the specifications and make of the materials, mentioned in the annexure. Any deviation will summarily reject the items of the work and not qualify for payment.
21. The successful tenderers shall be ready to carry out works between non banking hours and even at nights and holidays. The contractor should sign all the pages of the document and the same shall be submitted to us.

Acceptance of contractor for Labor laws

- The successful tenderers / Contractor shall carefully and diligently implement the provisions of the Contract Labor Act & Contract Labor Rules.
- The Bank shall be entitled to deduct from the Contract Consideration, any such amount which the Bank has to pay in accordance with the Contract Labor (Regulation & Abolition) Act 1971 and Workmen's Compensation Act, in the event of the Bank having to disburse compensation / effect any payment under the Contract Labor Acts / Rules.
- Please note that as per rule 81(1) of Contract Labour (R&A) Rules, 1971, it is mandatory on the part of the Contractor to the display the notice containing the following details at prominent place at the work site.
 - a) Rates of wages.
 - b) Hours of work.
 - c) Wage periods.
 - d) Dates of payment of wages.
 - e) Names & addresses of the Labor Inspectors having jurisdiction &
 - f) Date of payment of unpaid wages.

The notice containing the above details shall be displayed without fail at the work site.

1. The Contractor shall not engage any workmen for wages, less than the minimum wages prescribed under the notification issued by the Central Government.

SIGNATURE OF THE TENDERER



CANARA BANK, GA SECTION, CIRCLE OFFICE, HYDERABAD

2. The contractor should follow all labor laws/guidelines laid down by central /state government from time to time.

3. **ABNORMALLY HIGH AND LOW RATED ITEMS :**

For item rate tenders if, the rates quoted by the lowest bidder for certain items of the Bill of Quantities of the tender are found to be abnormally high or low in comparison to the market rate analysis of the item done by the Architects/Bank and or in comparison to Architect/Bank's method of working out market rate justification for the items, the same shall be governed as under in order to avoid financial loss to the Bank in the event of default of Bidders.

- i. For abnormally high rated items (AHR), the progressive payment shall be 80% (eighty percent) of the payment due to the Bidder against execution of the AHR item. The balance withheld 20% payment shall be released after 75% of total value of the original contract is complete in financial terms or this 20% withheld payment can be released to the Bidder on submission of an unconditional bank guarantee of equivalent amount in the proforma of Bank. Further deviation limit for AHR items shall be nil on plus side and Bank reserves the right to restrict, substitute or not execute the AHR items during execution. The decision of the Architect/Bank's Engineer in this regard shall be final and binding on the Bidder.
- ii. For abnormally low rated (ALR) items the Bidder shall submit Bank Guarantee of difference in total of amount of ALR item(s) and the total amount of corresponding items at market rate of the Architect/Bank. This bank guarantee shall be valid till completion of the project. In exceptional circumstances, the amount of Bank Guarantees (BG) may be reduced or BG released earlier than completion period if, in view of Architect/Bank's Engineer, all ALR items as provided in the contract are executed as per terms of contract and/or not required to be executed.

Notwithstanding what is contained in Para i) & ii) above, the provisions of Para (i) and (ii) shall not be applicable on tenders invited on percentage rate basis.

The decision of the Bank on identification/ marking of AHR and ALR item are final and binding on the Bidder. In case the Bidder do not agree for furnishing of Bank Guarantee as above towards ALR items, at the time of award of works, the EMD/Performance guarantee of the Bidder shall be forfeited and decision of Architect in this regard shall be final and binding on the Bidder.

CERTIFICATE

I/ WE HAVE READ, FULLY UNDERSTOOD THE ABOVE MENTIONED REGULATIONS OF LABOUR LAWS/GUIDELINES AND ACCEPT THE SAME IN TOTO. I ALSO UNDERTAKE TO FOLLOW ALL LABOUR LAWS/GUIDELINES LAID DOWN BY CENTRAL /STATE GOVERNMENT FROM TIME TO TIME & INDEMNIFY THE BANK AUTHORITIES.

CANARA BANK, GA SECTION, CIRCLE OFFICE, HYDERABAD

ANNEXURE I (TO BE MANDATORILY FURNISHED)

| | | |
|----|---|--|
| 1. | Name of the Contractor under the Contract Labor (Regulation and Abolition) Act, 1970 (37 of 1970) (if applicable) | |
| 2. | LIN / PAN No | |
| 3. | Email Id | |
| 4. | Mobile No. | |
| 5. | No. & date of Certificate of Registration/ License* | |
| 6. | Name of Person in charge of work | |
| 7. | LIN / PAN No. of the person in charge of work | |
| 8. | Email Id of the person in charge of work | |
| 9. | Mobile No. of the person in charge of work | |

* Please strike off whichever is not applicable

SIGNATURE OF THE TENDERER



CANARA BANK, GA SECTION, CIRCLE OFFICE, HYDERABAD

APPROVED LIST OF MATERIALS

| SL NO | ITEMS | MAKES |
|-------|--|--|
| 1 | MCCB / MCB - C Curve (All 10 kA Category) | Legrand, L & T, Merlin Gerin, Hager, GE, Schneider Electric. |
| 2 | ISOLATOR | LEGRAND |
| 3 | SWITCHES , SOCKETS (MODULAR) & MODULAR BOX | LEGRAND (MYRIUS / ARTEOR) / ANCHOR-WOODS/SCHNEIDER (ZENCELO), MK India Wraparound |
| 4 | CHANGE OVER SWITCH | L&T/ C&S/HPL |
| 5 | INSULATED WIRES (FRLS) CABLES | FINOLEX / HAVELS/RR Kabel/Polycab |
| 6 | CABLE GLANDS & LUGS | SIEMENS |
| 7 | POWER CABLES | Finolex/ Polycab /HAVELS |
| 8 | LIGHT FITTINGS | HAVELL'S /WIPRO/ PHILIPS/ CROMPTON GREAVES |
| 9 | FAN | (CROMPTON / HAVELL'S) (WHITE COLOUR) |
| 10 | 16" WALL FAN | CROMPTON/HAVELLS/ USHA (WHITE COLOUR) |
| 11 | 12"/9" EXHAUST FAN | CROMPTON/HAVELLS/ USHA with double ball bearing only |
| 12 | DBS | Hager, Merlin Gerin, Legrand, GE, L & T |
| 13 | TIMER | LEGRAND Model: 649 915 / SIEMENS |
| 14 | ELECTRONIC REGULATORS | LEGRAND/ANCHOR/SCHNEIDER, MK India |
| 15 | CASING CAPPING | MODI'S, GEMINI with ISI MARK |
| 16 | PVC conduit Pipe White/grey colour FRLS pipes only. | Avon Plast, Precision, Polycab, G.M with ISI mark |
| 17 | G.I. B-CLASS PIPES (ISI) | ITC, PRAKASH |
| 18 | Telephone Wires/Cables | Delton, Finolex/ R.R Kabel (0.5 mm dia) |
| 19 | MEASURING INSTRUMENTS | A.E., IMP, MECCO, SIEMENS |
| 20 | DOUBLE RJ 11 | ANCHOR ROMA / LEGRAND |

NOTE: Any brands indicated under the items specifications in the Bill of quantities will prevail over the above indicated makes. Apart from the above makes, any further equivalent make as approved by the Bank, can also be used with prior permission from the Bank and the consultant. Samples are to be approved by Bank and the Consultant if any.

COLOUR CODING: Color coding of wires to be followed strictly and all the DB boards to be named RED - Phase, BLACK - Neutral, GREEN - Earth

WARRANTY OF ABOVE ITEMS to be specified

SIGNATURE OF THE TENDERER



CANARA BANK, GA SECTION, CIRCLE OFFICE, HYDERABAD

Certificate to be submitted by the contractor on completion of works

Format of Installation Test Certificate

(To be submitted by the contractor on completion of works)

- I This is to certify that work is carried out confirming to IE rules and code of practice.
- II Test report is under
- a Insulation resistance test

| | | | |
|-----|-----|--------|--|
| R-N | ___ | M Ohms | |
| Y-N | ___ | M Ohms | |
| B-N | ___ | M Ohms | |

 - b Load test

| | | | |
|-------------|-------------|--|---------|
| 5 A-1000 W | power point | | 15 |
| | | | minutes |
| 15 A-3000 W | power point | | 15 |
| | | | minutes |

 - c Earth resistance for each electrode

| | | | |
|---|------------|--|-----|
| 1 | | | ohm |
| 2 | | | ohm |
| 3 | | | ohm |
| 4 | -N-E Volts | | |

 - d Wiring continuity test Yes /
No
 - e Earth continuity test Yes /
No
 - f Certificate of makes of material used in the work
 - g Circuit diagram
 - h Certified that the electrification work has been carried out under the supervision of licensed electrical supervisor
 - i Certified that the earthing plate / pipe has been verified and placed at correct depth confirming to IE rules.

Signature of Electrical Supervisor

Name:

License No.



CANARA BANK, GA SECTION, CIRCLE OFFICE, HYDERABAD

BRANCH LAYOUT

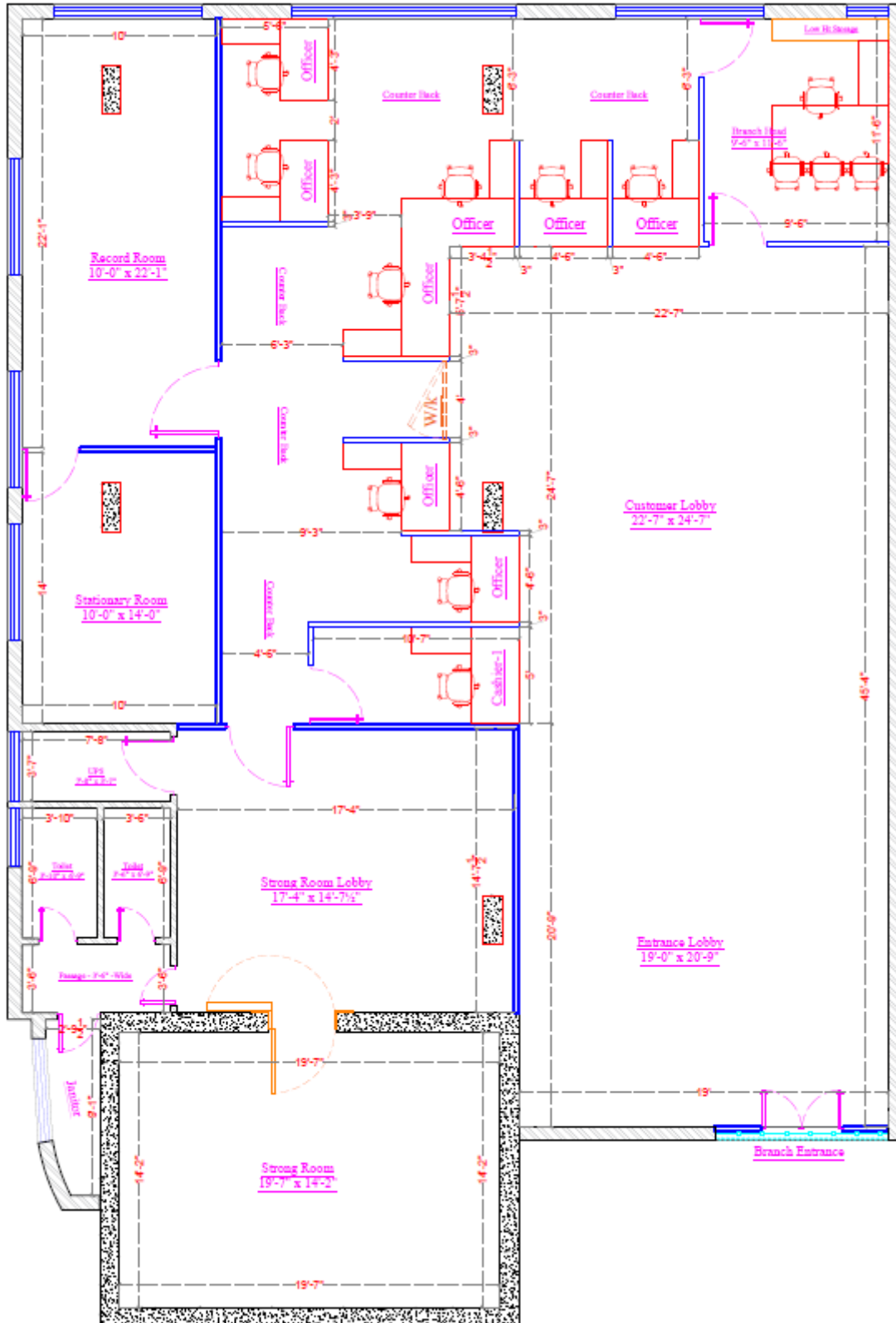

SIGNATURE OF THE TENDERER



CANARA BANK, GA SECTION, CIRCLE OFFICE, HYDERABAD

PRICE BID

| SNO | ITEM DESCRIPTION | QTY | UNIT | RATE | AMOUNT |
|-----|--|-------|------|------|--------|
| | PART A : ELECTRICAL & DATA CABLE WORKS | | | | |
| 1 | 2x2 36W LED recessed mounting light fitting (Havells/Wipro/Crompton/Philips or Equivalent) including cost and conveyance of all materials, taxes and all labor charges etc., complete. with all inter connections and fixing arrangement (should be hanged with the help of chains/GI from the ceiling) as required. The price should be include fixing arrangement in Gypsum/ Grid ceiling etc. | 36.00 | Nos | | |
| 2 | 15 W LED recessed mounting downlight fitting (Havells/Wipro/Crompton/philips or Equivalent) including cost and conveyance of all materials, taxes and all labor charges etc., complete | 25.00 | Nos | | |
| 3 | Supply & Fixing of 400 mm sweep Wall mounted fan (plastic blade) with 3 pin Plug on the lead wire of each fan all accessories Electrical connections. Including fixing materials required. (Havells Swing model or Crompton Hi Flo Make or equivalent) | 10.00 | No | | |
| 4 | Supply and fixing of 4' Led Tube Lights | 11.00 | No | | |
| 5 | Supply and fixing Ceiling Fans High speed Crompton make with suitable all fixing materials etc. Supply & Fixing | 3.00 | No | | |
| 6 | Exhaust Fans 9" for wash rooms | 2.00 | No | | |
| 7 | Primary Point : Supply and wiring of Light and fan Points with Switch. MS Box, Plate and also Suitable Size 2mm thick PVC conduit with 3x1.5Sqmm Copper multistrand flexible pvc insulated cable (FRLS) with required all Materials etc. (Rate including the circuit wiring from Lighting Distribution Board to Switch Board Wiring 2x2.5+1.5Sqmm Wire and PVC Conduits) | 49.00 | Pts | | |
| a | Looping/Secondary Point Supply & Wiring | 36.00 | Pts | | |
| 8 | Supply and wiring of Bell point with bell Push and Ding Dong Bell with Suitable Size 2mm thick PVC conduit with 3x1.5Sqmm earth wire Copper multistand flexible pvc insulated wires and 5A Switch cum sockets with Surface/Concealed Box with required all materials etc. Supply & Fixing | 1.00 | set | | |

SIGNATURE OF THE TENDERER



CANARA BANK, GA SECTION, CIRCLE OFFICE, HYDERABAD

| | | | | | |
|----|---|--------|-----|--|--|
| 9 | Supply and wiring of Wall Mounting Fan points from Near with 3x1.5Sqmm earth wire Copper multistand flexible pvc insulated wires and 5/6A Switch cum sockets with Surface/Concealed Box with required all materials etc. | 10.00 | set | | |
| 10 | A/C Points: Supply and wiring of Circuits for Acs with Suitable 2mm thick PVC Conduit and 2x4.0Sqmm + 2.5Sqmm earth wire Copper multistand flexible pvc insulated wires (FRLS) with Supply and fixing of Metal Clad socket and 25/32A SP MCB and all required all materials etc. Supply & Fixing. | 4.00 | set | | |
| 11 | SWITCH CUM SOCKETS Supply and fixing of 1No. 6A Sockets with 6A Switch control for above Switch Control Boards with suitable Surface/MS Boxes etc. Including Connections | 7.00 | Nos | | |
| 12 | Supply and fixing of 2No. of 16A Sockets with 1 No. of 16A Switch control for Raw/UPS Power with Suitable Surface/MS boxes etc. Supply& Fixing | 10.00 | Nos | | |
| 13 | Supply and fixing of 3 No. of 6A Sockets with 2 No. of 16A Switch control for Raw/UPS Power with Suitable Surface/MS boxes etc. Supply & Fixing | 22.00 | Nos | | |
| 14 | UPS Wiring: Supply and wiring of Circuits for UPS power from UPS DB to individual Tables with suitable 2mm thick PVC Conduit and 2x2.5 Sqmm + 2.5 Sqmm earth wire Copper multistand flexible pvc insulated wires with required all materials etc. | 11.00 | Pts | | |
| a | Secondary point | 11.00 | Pts | | |
| 15 | Supply and wiring of Circuits for Raw power from RAW Power DB to individual tables with Suitable 2mm thick PVC Conduit and 2x2.5 Sqmm +1.5 Sqmm earth wire Copper multistand flexible pvc insulated wires with required all materials etc. Supply & Wiring | 5.00 | Pts | | |
| a | Secondary point | 5.00 | Pts | | |
| 16 | EARTHING: Supply, fixing, testing & commissioning of earthing Earthpit with copper plate 600x600x3mm thick, 25x6mm copper flat, 40mm GI pipe, 100KG charcoal 100KG salt, funnel, mesh, cover etc. Digging depth up to 7 | 2.00 | Nos | | |
| 17 | Supply and fixing of 8SWG bare Copper wire with suitable PVC conduit required all materials etc. | 100.00 | Mts | | |
| 18 | Supply and wiring of telephone points including wiring with 4 pair copper cable and suitable conduit, required all materials ect. & GI boxes with Telephone socket (RJ-11) with mounting box & front plate complete in all respect. | 10.00 | Nos | | |

CANARA BANK, GA SECTION, CIRCLE OFFICE, HYDERABAD

| | | | | | |
|----|--|-------|-----|--|--|
| 19 | Supply and fixing of 30 Pair Termination EPBX Box with Connectors | 1.00 | No | | |
| 20 | Supply and wiring of Circuits for inputs with Suitable Size 2mm thick PVC Conduit and 4x6.0Sqmm+4.0Sqmm earth wire Copper multistand flexible pvc insulated wires with required all materials etc. (LDB Input) | 70.00 | Mts | | |
| 21 | Supply and wiring of Circuits for Input with Suitable size 2mm thick PVC Conduit and 4x6.0Sqmm +4.0Sqmm earth wire Copper multistand flexible pvc insulated wires with required all materials etc. (UPS input) | 30.00 | Mts | | |
| 22 | Supplying, laying, testing & commissioning of 4 C X 25 sq.mm. at 1100 volts grade XLPE insulated aluminum conductor armoured cable with 10 gauge earth copper wire including cables end termination using appropriate Lugs, Glands, termination accessories, Clamps etc. as required as per specification (AC DB + RAW POWER DB). | 20.00 | Mts | | |
| 23 | Supplying, laying, testing & commissioning of 4 C X 50 sq.mm. at 1100 volts grade XLPE insulated aluminum conductor armoured cable with 10 gauge earth copper wire including cables end termination using appropriate Lugs, Glands, termination accessories, Clamps etc. as required as per specification (MAINS). | 30.00 | Mts | | |
| 24 | DISTRIBUTION BOARD(Double Door DBS) | | | | |
| | Supplying, installing, testing & commissioning of surface/recessed mountings, Double door 415 volts TPN MCB distribution board of steel, 1.6 mm thick dust phosphatized and painted, inclusive of 100 amps, tinned copper bus bars, earth bar, common neutral link, din bar for mounting of MCB's detachable gland / knock out plate & with built in loose wire box, and superior make terminal connectors for all incoming and outgoing circuits duly prewired with adequate size of PVC insulated copper wires between the bus bars and the MCB's as well as the incomer and up to the terminal connectors/ neutral link and ready for installation of following ways as required. | | | | |
| | Use 'B' curve MCB's for lighting & small power circuits, 'C' curve for motor duty i.e. for pumps, AC motors, window and split AC's etc.& 'D' curve for UPSDB's i.e. for computers/ PC's circuit. Main incomer & outgoing circuit MCB's shall be selected accordingly i.e. type B, C & D. Contractor to select the MCB's accordingly as per the nature of the circuit/ load. | | | | |

CANARA BANK, GA SECTION, CIRCLE OFFICE, HYDERABAD

| | | | | | |
|---|---|------|----|--|--|
| | Each DB shall have separate neutral links of rating not less than 100A for each phase. The main incoming neutral link shall be in addition to three outgoing neutral links and shall be of 125 A. | | | | |
| | UPS DB's shall have a dedicated Earthing link fixed on insulated supports, which will be in addition to body earth link. | | | | |
| | All internal inter connecting wiring within the DB's shall be PVC insulated flexible copper conductor wires of adequate capacity as per the current rating. Inside each DB, a DB chart is to be fixed. | | | | |
| A | <p>MAIN DBS / SUB DBS- Supply Installation Testing and commissioning of TPN MCB Double door Distribution boards dust and vermin protected and rated for 415V, Three Phase AC supply operation including incoming MCB/ELCB as per specifications and required capacity Neutral bar and Earth terminal complete as required and installed in flush with wall including all fixing materials required. MCBs shall conform : 8828 and ELCB /RCCB shall conform to IS : 12640</p> <p>a)Supply, installation, testing and commissioning of (Double door) with 8Way VTPN MCCB DPX DB with 100A 4Pole MCCB as incomer and 63A TPMCBs - 2 Nos, 40A TP MCbs- 2 Nos, and 12 nos 10/32A SPMCBs s outgoing. (for MAIN DB)</p> | 1.00 | No | | |
| B | <p>6-way TPN DB (LIGHT DB): Incomer:- 1 No. 40 Amp TPN (10 KA) MCB with 3 No of 25 A DP RCCB (30 mA) each phase Outgoing:- 12 Nos.6/10 Amp (10 KA) SP MCB</p> | 1.00 | No | | |
| C | <p>4-way TPN DB (Power DB) Incomer :- 1 No. 40 Amp TPN (10 KA) MCB with 3 No of 25 A DP RCCB (30 mA) each phase Outgoing :- 6 Nos. 10/16/25/32 Amp (10 KA) SP MCB</p> | 1.00 | No | | |
| D | <p>6-way TPN DB (AC DB) Incomer :- 1 No. 63 Amp TPN (10 KA) MCB with 1 No of 63 A 4P RCCB (100 mA) Outgoing :- 9 Nos. 10/16/25/32 Amp (10 KA) DP MCB</p> | 1.00 | No | | |
| E | 12-way SPN DB with 1 Nos. 40 A (10 KA) DP MCB for incoming and 10 Nos. 10/16/25/32 Amp (10KA) SP MCB (For UPS Output - SDB) | 1.00 | No | | |

SIGNATURE OF THE TENDERER



CANARA BANK, GA SECTION, CIRCLE OFFICE, HYDERABAD

| | | | | | |
|----|---|-------|-----|--|--|
| F | 8-way SPN DB with 1 Nos. 40 A (10 KA) DP MCB for incoming and 6 Nos. 10/16/25/32 Amp (10KA) SP MCB (For UPS Output - SDB) | 2.00 | No | | |
| 25 | Supply & fixing of 3 Phase 63A Manual Phase Changeover Switch without OFF for UPS input. (L&T Make) | 1.00 | No | | |
| 26 | Supplying and fixing FP sheet steel enclosure on surface/ recess along with 63 A 415 V "C" curve TPN MCB complete with connections, testing and commissioning etc. as required. UPS INPUT | 1.00 | No | | |
| 27 | Supplying and fixing DP sheet steel enclosure on surface/ recess along with 40A 240 V "C" curve DP MCB complete with connections, testing and commissioning etc. as required. UPS INPUT | 3.00 | No | | |
| 28 | Supplying and fixing DP sheet steel enclosure on surface/ recess along with 40A 240 V "C" curve DP MCB complete with connections, testing and commissioning etc. as required. UPS OUTPUT | 3.00 | No | | |
| | LAN CABLING | | | | |
| 29 | Supply and Laying of 4Pair, UTP cat6E Lan Cable with Information outlet and Suitable 2mm Thick PVC Pipe Laying Below Flooring/Wall/Slab etc MS Junction Boxes to All Tables , Including all Related Civil Works etc All Cable Numbers to be Provided at both ends(systimax) | 20.00 | Pts | | |
| 30 | Supply & fixing of 7 feet Patch Cords. | 20.00 | Nos | | |
| 31 | Supply & fixing of 3 feet Patch Cords. | 20.00 | Nos | | |
| 32 | Supply & fixing of 24 patch panel | 1.00 | Nos | | |
| 33 | Supply & Fixing of 12U Rack | 1.00 | Nos | | |
| 34 | Supply & Installation of rubber mats (Class-A) of 1000 mm x 2000mm & thickness of 10mm: 3.3 KV Voltage grade | 1.00 | Nos | | |
| 35 | Supply and wiring of Inverter wiring using of 2 Core 2.5 Sqm and 1 core of 1.5 sqmm for Inverter to DB's, Item including out put and in put wiring using of 2 Core 4 Sqmm and one core of 2.5 sqmm, item including of input and out put 16A sockets, item including all necessary items, labour charges, complete for the finished item of work. | 1.00 | LS | | |
| 36 | Charges towards removal of existing wiring during civil/renovation work and giving temporary connections of light points, UPS, raw and Data supply to counters and cabins using extension boards from existing panel /server using existing old materials. Contractors has to arrange the materials at his own cost if any additional cables, switch boards are required at site for smooth | 1.00 | LS | | |

CANARA BANK, GA SECTION, CIRCLE OFFICE, HYDERABAD

| | | | | | |
|----|---|------|----|--|--|
| | functioning of Branch. cost Includes necessary modification in main panel for master switch & load balancing etc. | | | | |
| 37 | Installation of RGB indicator set at the entrance of the branch showing the output of LDB, UPS SDB, AC and Raw Power DB with necessary wiring and equipment related | 1.00 | LS | | |
| 38 | Preparation of the Single Line Diagram (SLD) auto cad drawing for the VTPN DB, AC DB, Power DB, Lighting DB input, SPN DB's input and output along with circuit wiring, point wiring, lan wiring, AC wiring, inverter wiring, complete for the finished item of work. | 1.00 | LS | | |
| | Total of Part A - (Excl GST) | | | | |

| | | | | | |
|----------------------------|---|-----|-----|--|--|
| PART - B : AC Works | | | | | |
| 1 | Supply of following INVERTER TYPE AC unit along with 3 Mtrs Refrigerant piping & cabling, irrespective of the number of circuits & stand for the condensing unit (Make: - Voltas/ Blue Star/ Carrier/ LG/ Daikin) (Energy Rating : Minimum Three Star Rating) | | | | |
| a | 1.0 TR SPLIT AC UNIT | Nos | 1.0 | | |
| b | 1.5 TR SPLIT AC UNIT | Nos | 0.0 | | |
| c | 2.0 TR SPLIT AC UNIT | Nos | 0.0 | | |
| d | 3.0 TR CASSETTE AC UNIT | Nos | 3.0 | | |
| 2 | Installation, Testing & Commissioning of following INVERTER TYPE AC unit along with 3 Mtrs. Refrigerant piping & cabling, irrespective of the number of circuits & stand for the condensing unit (Suction line to be insulated with elastomeric nitrile rubber tubular insulation of 9mm thickness adhesive & joints sealed with black monsoon tape). Rate quoted should be inclusive of charges for core cutting and closing the same with sealant with smooth finish. (Make: - Voltas / Blue Star / Carrier / Hitachi) (Energy Rating : Minimum Three Star Rating) | | | | |
| a | 1.0 TR SPLIT AC UNIT | Nos | 1.0 | | |
| b | 1.5 TR SPLIT UNIT | Nos | 0.0 | | |
| c | 2.0 TR SPLIT AC UNIT | Nos | 0.0 | | |
| d | 3.0 TR CASSETTE AC UNIT | Nos | 3.0 | | |
| 3 | SITC of digital voltage stabilizer of suitable capacity for Air-Conditioners | Nos | 1.0 | | |

CANARA BANK, GA SECTION, CIRCLE OFFICE, HYDERABAD

| | | | | | |
|-------------------------------------|---|-----|------|--|--|
| 4 | SITC of requisite copper refrigerant pipe with Foam insulation between indoor and outdoor units, with breaking of walls making core cutting in walls, making grove cutting in walls & floors and filling the same with appropriate materials and making good of the same wherever required for Split Air Conditioners as per site conditions. | Rmt | 80.0 | | |
| 5 | SITC of 19/25 mm PVC conduit pipe to be used as a drain water pipe with breaking of walls making core cutting in walls, making grove cutting in walls & floors and filling the same with appropriate materials and making good of the same wherever required for Split/Cassette Air Conditioners as per site conditions. | Rmt | 80.0 | | |
| 6 | Supply and Laying of electric control FRLS cable of 2.5 Sqmm with breaking of walls making core cutting in walls, making grove cutting in walls & floors and filling the same with appropriate materials and making good of the same wherever required for Split/Cassette Air Conditioners as per site conditions. | Rmt | 80.0 | | |
| 7 | SITC of L shape / suitable shape M S frame stand for mounting outdoor units on wall / roof, complete with all fixing hardware. | Nos | 4.0 | | |
| 8 | SITC of wall mounted Digital Cyclic Timer with 30A rating, time setting from 1hour to 12 hours, suitable for two A/c's with LCD display. Make: RMG automation, Dynamic Micro Tech (2 Hours on 2 Hours Off) | Nos | 0.0 | | |
| Total of Part B - (Excl GST) | | | | | |
| TOTAL (PART A + PART B) | | | | | |
| DISCOUNT (IF ANY) | | | | | |
| GRAND TOTAL (Excl GST) | | | | | |

Final Amount in words: _____

Note :

1. Bank is at liberty to split the works for Part A & Part B

SIGNATURE OF THE TENDERER



CANARA BANK, GA SECTION, CIRCLE OFFICE, HYDERABAD

2. Incomplete Tenders will be out rightly rejected.
3. Entire tender document is to be printed and rates are to be filled by pen. Any tender submitted by copying the contents of this document will be rejected.

SIGNATURE OF THE TENDERER

