

# OPTION-02

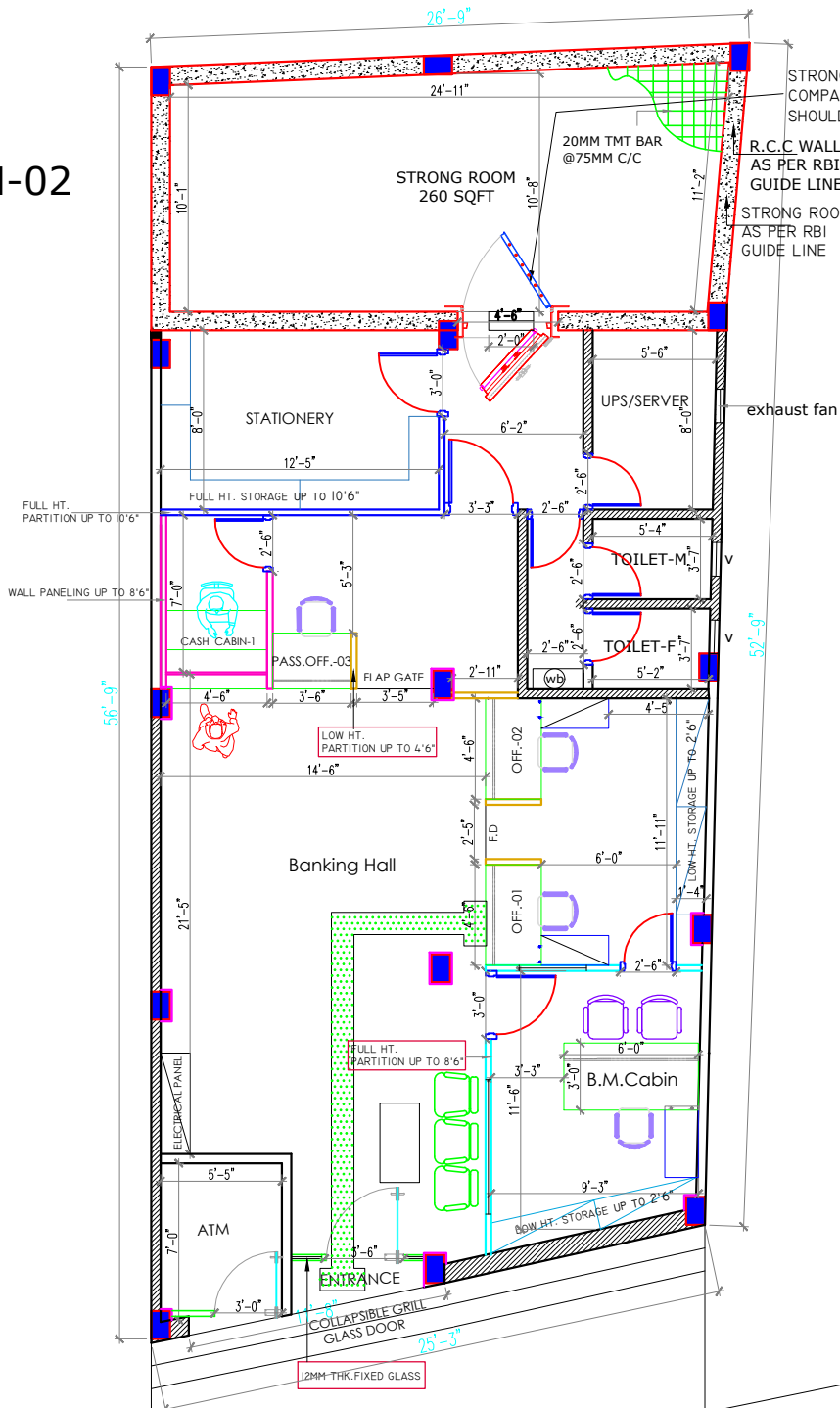

LEGEND	
	GLAZED PARTITION FOR MANAGER CABIN
	SEMI GLAZED DOUBLE SIDED LAMINATE PARTITION
	HALF HEIGHT TABLE PARTITION WITH GLAZING & DOUBLE SIDED LAMINATE
	CASH COUNTER PARTITION WITH GLAZING & DOUBLE SIDED LAMINATE
	FULL HEIGHT PARTITION UP TO 11'7"
	COLUMN PANELING/WALL PANELING
	12MM THK. FIXED GLASS
	5"/10" THK. BRICK WORK

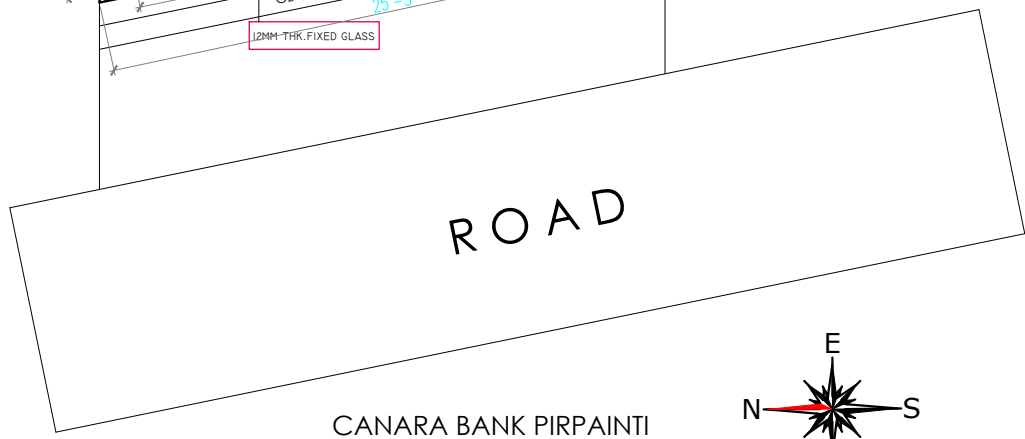

TOTAL CARPET AREA-1166+39=1205 SQFT

Ceiling hight-10'6"  
Beam hight-9'8"

BRANCH AT-GROUND FLOOR

<b>Notes :</b> ALL DIMENSIONS ARE TO BE CHECKED AND CO-RELATED WITH THE RELEVANT ARCHITECTURAL & STRUCTURAL DRAWINGS AND ANY AMBIGUITY SHALL BE IMMEDIATELY BROUGHT TO THE NOTICE OF THE ARCHITECTS BEFORE COMMENCEMENT OF THE WORK. THIS DRAWING IS THE PROPERTY OF ATTIK ARCHITECTS AND IS NOT TO BE COPIED OR USED WITHOUT THEIR PERMISSION.	<b>Architects :</b> ATTIK ARCHITECTS a r c h i t e c t SITHLA ASTHAN ROAD, NEAR TILKAMANJHI THANA, BHAGALPUR, PH. NO. 7503821328 9430546484,989667289	<b>Drawing Title:-</b> PIRPAINTI BRANCH	<b>REVISIONS :</b> <table border="1"> <thead> <tr> <th>Sl.No</th> <th>Date</th> <th>Issue</th> <th>Change</th> </tr> </thead> <tbody> <tr> <td> </td> <td> </td> <td> </td> <td> </td> </tr> <tr> <td> </td> <td> </td> <td> </td> <td> </td> </tr> <tr> <td> </td> <td> </td> <td> </td> <td> </td> </tr> </tbody> </table>	Sl.No	Date	Issue	Change													Date:- 16-07-2025 Scale:- NTS DRG. NO:-01	Checked by: AR.VIKASH KR. Dealt by:	NORTH : R 1
	Sl.No	Date	Issue	Change																		
<b>Consultants :</b>	Client : CANARA BANK	Job Title :	ATTIK ARCHITECTS <small>This drawing/design is property of Attik architects. No part of this may be reproduced or implemented in any form without prior permission in writing from Architects. Any person doing so, shall be liable to criminal prosecution and civil claims for damages.</small>																			