

KAHALGAON BRANCH

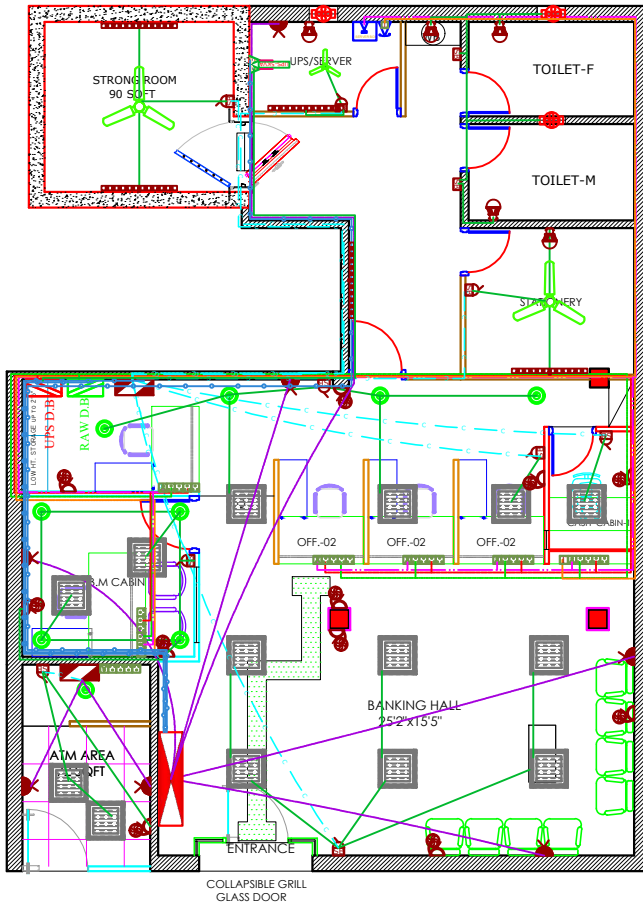

TOTAL CARPET AREA = 1134 SQFT

LEGEND

SYMBOL	DESCRIPTION	HEIGHT
	U.P.S POWER POINT	
	3No. 5Amp. SOCKET & SWITCH	
	RAW POWER POINT	
	2No. 5Amp. SOCKET & SWITCH	
	NETWORKING POINT (CAT-6 WIRE)	
	TELEPHONE POINT	
	NETWORKING SWITCH	
	E.P.B.X	
	RAW POWER D.B.	
	U.P.S-POWER D.B.	
	U.P.S PRIMARY & SECONDARY SWITCH & SOCKET	
	CEILING FAN	ON CEILING
	40WX40" TUBE LIGHT FITTING	8'6"
	1X18W / 1X23W C.F.L	8'6"
	CEILING LIGHT	ON CEILING
	SWITCH BOARD WITH 5AMP SOCKETS	4'6" HT
	5 AMPS SWITCH SOEKET	1'6" HT
	15 AMPS SWITCH SOEKET	1'6" HT
	2X2 LED. LIGHT CEILING	
	25 AMPS SWITCH SOEKET (A.C)	1'6" HT
	EXHAUST FAN (IN TOI & KIT)	
	DISTRIBUTION BOARD	
	L.T MAIN CONTROL PANEL	
	WALL- FAN	5'6" HT

	ROUTE OF UPS. POWER WRING.(25MM)
	ROUTE OF RAW POWER WRING.(25MM)
	ROUTE OF NETWORKING WIRING
	ROUTE OF TV WIRING (25MM)
	ROUTE OF POINT WIRING (19MM)
	ROUTE OF POINT WIRING (25MM)
	ROUTE OF CIRCUIT WIRING (25MM)
	ROUTE OF SUB MAIN WIRING(2X25MM)
	ROUTE OF POWER POINT WRING.(25MM)
	ROUTE OF AC. POINT WRING.(25MM)

	ROOT OF TELEPHONE WIRING
	COMPUTER WIRING ROTE
	UPS POWER WIRING ROTE
	2Nos 25mm dia PVC pipe layingin floor/wall/false ceiling for each computer power line.
	RAW POWER WIRING ROTE

Architects :
ATTIK ARCHITECTS
 architect
 SITHLA ASTHAN ROAD, NEAR
 TILKAMANJHI TIANA, BHAGALPUR ,PH. NO.
 7503821328
 9430546484,9899677289

Drawing Title:-
 KAHALGAON BRANCH

REVISIONS :

Date:-
 25-07-2025

Checked by:
 KG. PRASAD

NORTH :



Scale:- NTS

Dealt by:
 RAHUL KR.

Consultants :

Client : CANARA BANK
 ELECTRICAL LAYOUT PLAN

ATTIK ARCHITECTS

This drawing/design is property of Attik architects. No part of this may be reproduced or implemented in any form without prior permission in writing from Architects. Any person doing so, shall be liable to criminal prosecution and civil claims for damages.

KRISHNA GOPAL PRASAD(B.E.ELECTRIC)
 (ELECTRICAL CONSULTANT) (EMAIL:-kgprasad62@gmail.com)
(COMPUTER AIDED ELECTRICAL DESIGNER)
 402, SUN RISE KAMLA REKHA SHREE, RAJ RAM BRIKSH PATH, NEHRU NAGER
 PATILPUTRA COLONY, PATNA (BIHAR) PIN CODE-800013. PHONE NO.-9431066889

ALL DIMENSIONS ARE TO BE CHECKED AND CO-RELATED WITH THE RELEVANT ARCHITECTURAL & STRUCTURAL DRAWINGS AND ANY AMBIGUITY SHALL BE IMMEDIATELY BROUGHT TO THE NOTICE OF THE ARCHITECTS BEFORE COMMENCEMENT OF THE WORK. THIS DRAWING IS THE PROPERTY OF ATTIK ARCHITECTS AND IS NOT TO BE COPIED OR USED WITHOUT THEIR PERMISSION.