

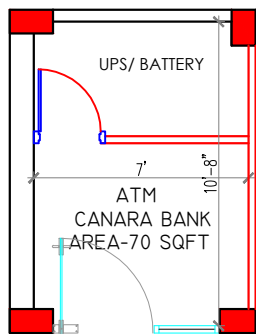





TOTAL CARPET AREA -1207 SQFT +70 SQFT ATM
 =1277 SQFT



LEGEND

	GLAZED PARTITION FOR MANAGER CABIN
	SEMI GLAZED DOUBLE SIDED LAMINATE PARTITION
	HALF HEIGHT TABLE PARTITION WITH GLAZING & DOUBLE SIDED LAMINATE
	CASH COUNTER PARTITION WITH GLAZING & DOUBLE SIDED LAMINATE
	FULL HEIGHT PARTITION WITH CEMENT BOARD INSIDE & PLY WITH LAMINATE OUTSIDE
	FULL HEIGHT PARTITION WITH BOTH SIDE CEMENT BOARD

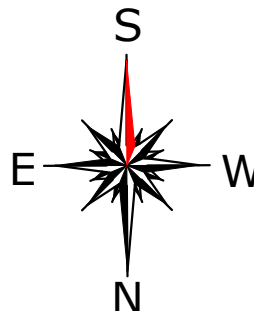

<p>Notes :</p> <p>ALL DIMENSIONS ARE TO BE CHECKED AND CO-RELATED WITH THE RELEVANT ARCHITECTURAL & STRUCTURAL DRAWINGS AND ANY AMBIGUITY SHALL BE IMMEDIATELY BROUGHT TO THE NOTICE OF THE ARCHITECTS BEFORE COMMENCEMENT OF THE WORK. THIS DRAWING IS THE PROPERTY OF ATIK ARCHITECTS AND IS NOT TO BE COPIED OR USED WITHOUT THEIR PERMISSION.</p>	<p>Architects : ATIK ARCHITECTS architect SITHLA ASTHAN ROAD, NEAR TILKAMANJHI THANA, BHAGALPUR, PH. NO. 7503821328 9430546484, 9899677289</p>	<p>Drawing Title:- CANARA BANK AMARPUR BRANCH</p>	<p>REVISIONS :</p> <table border="1"> <thead> <tr> <th>Sl. No.</th> <th>Date</th> <th>By</th> <th>Remarks</th> </tr> </thead> <tbody> <tr> <td> </td> <td> </td> <td> </td> <td> </td> </tr> <tr> <td> </td> <td> </td> <td> </td> <td> </td> </tr> <tr> <td> </td> <td> </td> <td> </td> <td> </td> </tr> </tbody> </table>	Sl. No.	Date	By	Remarks													<p>Date:- 31-07-2024 Checked by: AR.VIKASH KR. Scale:- NTS Dealt by:</p>	<p>NORTH :</p>
	Sl. No.	Date	By	Remarks																	
<p>Consultants :</p>	<p>Client : CANARA BANK</p>	<p>Job Title :</p>	<p>DRG. NO:-01</p>	<p>R 1</p>																	
<p>ATIK ARCHITECTS This drawing/design is property of Atik architects. No part of this may be reproduced or implemented in any form without prior permission in writing from Architects. Any person doing so, shall be liable to criminal prosecution and civil claims for damages.</p>																					