

PROPOSED LAYOUT PLAN

LEGEND	
	GLAZED PARTITION FOR MANAGER CABIN
	SEMI GLAZED DOUBLE SIDED LAMINATE PARTITION
	HALF HEIGHT TABLE PARTITION WITH GLAZING & DOUBLE SIDED LAMINATE
	CASH COUNTER PARTITION WITH GLAZING & DOUBLE SIDED LAMINATE
	FULL HEIGHT PARTITION UP TO 11'7"
	COLUMN PANELING/WALL PANELING
	12MM THK. FIXED GLASS
	5"/10" THK. BRICK WORK

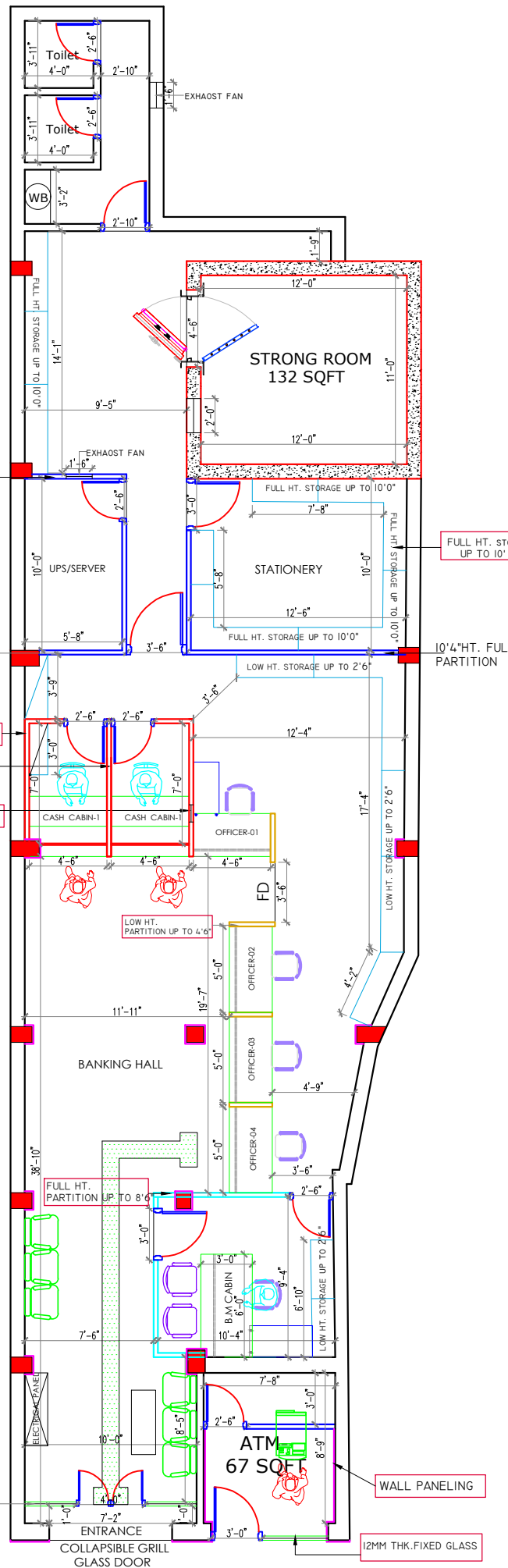

BRANCH AT GROUND FLOOR

BRANCH CARPET AREA=1430 SQFT

Ceiling hight-10'4"

Beam hight-8'9"

CANARA BANK BASOPATTI BRANCH

Notes :
ALL DIMENSIONS ARE TO BE CHECKED AND CO-RELATED WITH THE RELEVANT ARCHITECTURAL & STRUCTURAL DRAWINGS AND ANY AMBIGUITY SHALL BE IMMEDIATELY BROUGHT TO THE NOTICE OF THE ARCHITECTS BEFORE COMMENCEMENT OF THE WORK. THIS DRAWING IS THE PROPERTY OF ATTIK ARCHITECTS AND IS NOT TO BE COPIED OR USED WITHOUT THEIR PERMISSION.

Architects :
ATTIK ARCHITECTS
architect
SITHLA ASTHAN ROAD, NEAR
TILKAMANJHI THANA, BHAGALPUR, PH. NO.
7503321329
9430546484,9899677289

Drawing Title :-
BASOPATTI BRANCH
Internal

Client : CANARA BANK

REVISIONS :			
Sl.No	Date	Reason	Change

Job Title :

Date:- 11-12-2025
Checked by: AR.VIKASH KR.
Scale:- NTS
Dealt by:

DRG. NO:-01
R 1

ATTIK ARCHITECTS
This drawing/design is property of Attik architects. No part of this may be reproduced or implemented in any form without prior permission in writing from Architects. Any person doing so, shall be liable to criminal prosecution and civil claims for damages.