

option-2

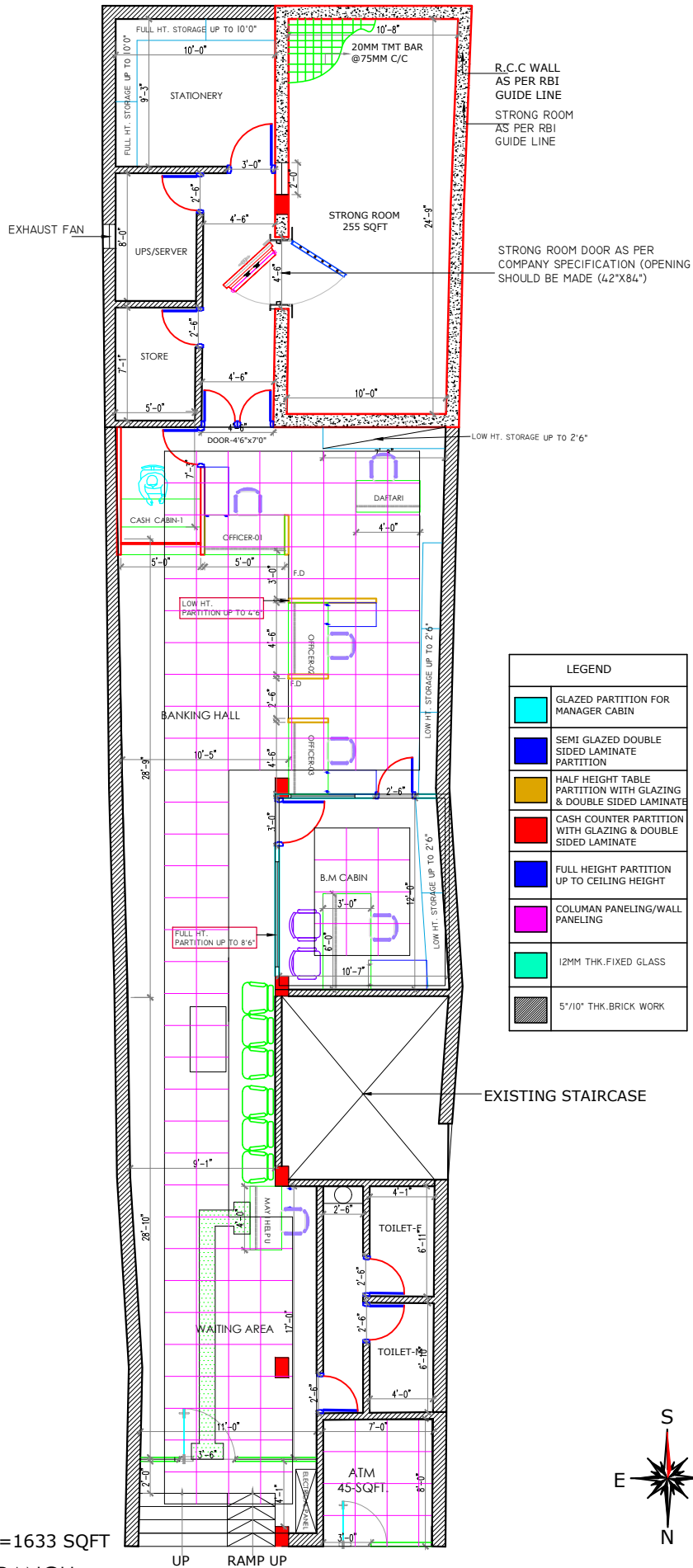

LEGEND	
	GLAZED PARTITION FOR MANAGER CABIN
	SEMI GLAZED DOUBLE SIDED LAMINATE PARTITION
	HALF HEIGHT TABLE PARTITION WITH GLAZING & DOUBLE SIDED LAMINATE
	CASH COUNTER PARTITION WITH GLAZING & DOUBLE SIDED LAMINATE
	FULL HEIGHT PARTITION UP TO CEILING HEIGHT
	COLUMN PANELING/WALL PANELING
	12MM THK. FIXED GLASS
	5"/10" THK. BRICK WORK

BRANCH AT GROUND FLOOR  
 CEILING HEIGHT-10'9"  
 BEAM HEIGHT-10'0"

CARPET AREA CALCULATION-1588+45=1633 SQFT  
**CANARA BANK SANGRAMPUR BRANCH**

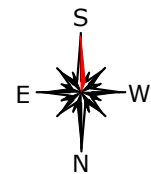

Notes : ALL DIMENSIONS ARE TO BE CHECKED AND CO-RELATED WITH THE RELEVANT ARCHITECTURAL & STRUCTURAL DRAWINGS AND ANY AMBIGUITY SHALL BE IMMEDIATELY BROUGHT TO THE NOTICE OF THE ARCHITECTS BEFORE COMMENCEMENT OF THE WORK. THIS DRAWING IS THE PROPERTY OF ATTIK ARCHITECTS AND IS NOT TO BE COPIED OR USED WITHOUT THEIR PERMISSION.	Architects : <b>ATTIK ARCHITECTS</b> architect SITHLA ASTHAN ROAD, NEAR TILKAMANJHI THANA, BHAGALPUR, PH. NO. 7503321329 9430546484, 9899677289	Drawing Title:- <b>SANGRAMPUR BRANCH</b> <b>Internal</b>	REVISIONS : Date    Desc    Status    Change	Date:- 19-07-2025	Checked by: AR.VIKASH KR.	NORTH :
	Consultants :	Client : CANARA BANK	Job Title :	Scale:- NTS	Dealt by:	DRG. NO:-01
<b>ATTIK ARCHITECTS</b> <small>This drawing/design is property of Attik architects. No part of this may be reproduced or implemented in any form without prior permission in writing from Architects. Any person doing so, shall be liable to criminal prosecution and civil claims for damages.</small>						