

Option-1

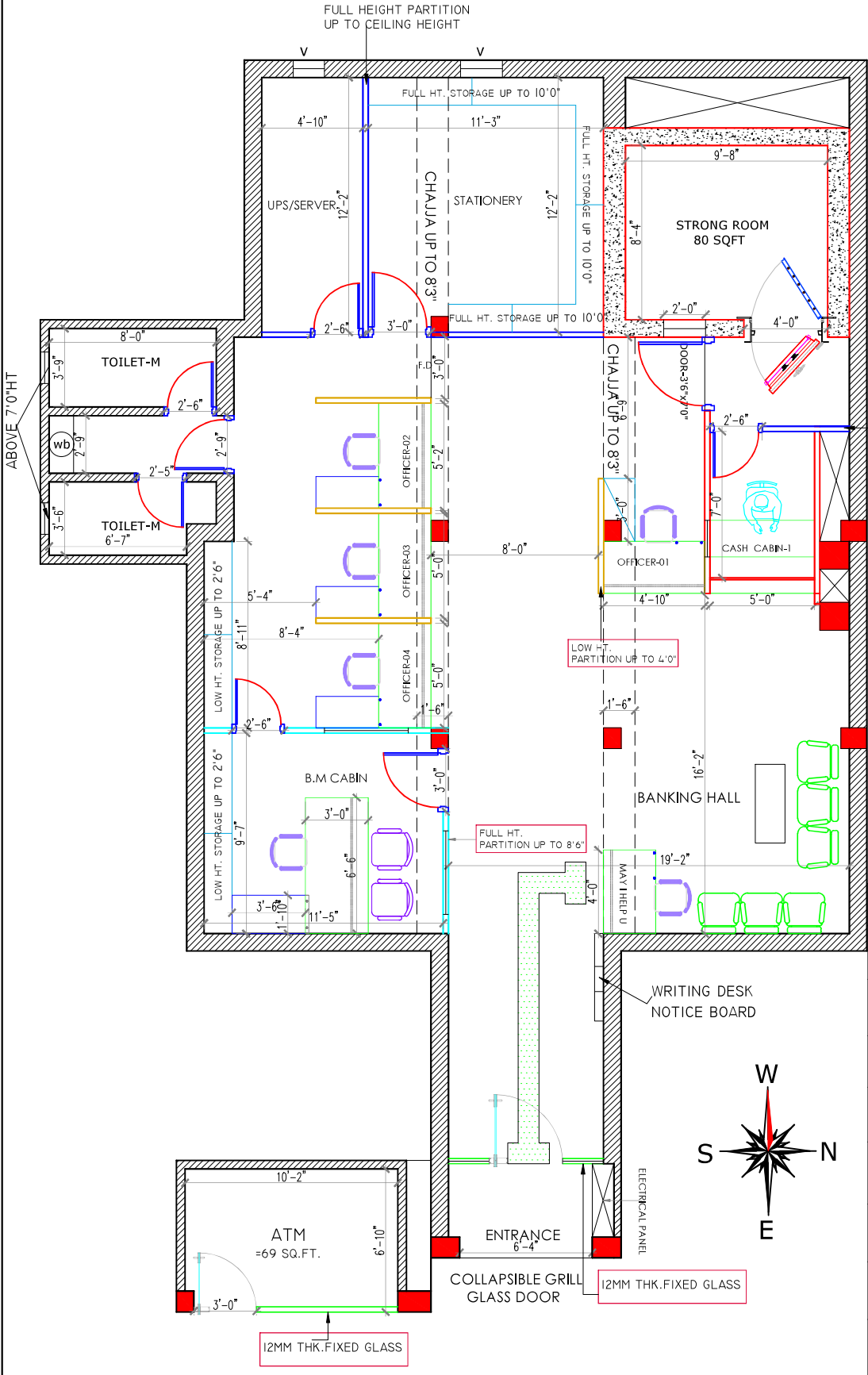

LEGEND	
	GLAZED PARTITION FOR MANAGER CABIN
	SEMI GLAZED DOUBLE SIDED LAMINATE PARTITION
	HALF HEIGHT TABLE PARTITION WITH GLAZING & DOUBLE SIDED LAMINATE
	CASH COUNTER PARTITION WITH GLAZING & DOUBLE SIDED LAMINATE
	FULL HEIGHT PARTITION UP TO CEILING HEIGHT
	COLUMN PANELING/WALL PANELING
	12MM THK. FIXED GLASS
	5/10" THK. BRICK WORK

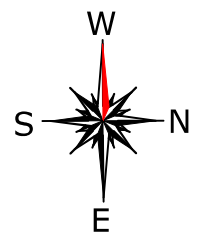

**CARPET AREA CALCULATION-1250+69=1319 SQFT**  
**Ceiling hight-12'6"/8'3"**

**Notes :**  
 ALL DIMENSIONS ARE TO BE CHECKED AND CORRELATED WITH THE RELEVANT ARCHITECTURAL & STRUCTURAL DRAWINGS AND ANY AMBIGUITY SHALL BE IMMEDIATELY BROUGHT TO THE NOTICE OF THE ARCHITECTS BEFORE COMMENCEMENT OF THE WORK. THIS DRAWING IS THE PROPERTY OF ATTIK ARCHITECTS AND IS NOT TO BE COPIED OR USED WITHOUT THEIR PERMISSION.

**Architects :**  
**ATTIK ARCHITECTS**  
 architect  
 SITHLA ASTHAN ROAD, NEAR  
 TILKAMANIKHI TRIANA, BHAGALPUR, PH. NO.,  
 7503821328  
 9430546484, 9899672289

**Consultants :**

**Drawing Title:-**  
**BARBIGHA BRANCH**  
**Internal**

**Client :**  
**CANARA BANK**

REVISIONS :			
Sl.No	Date	Issue	Change

**Job Title :**

**Date:-**  
 19-07-2025

**Checked by:**  
 AR,VIKASH KR.

**Scale:-** NTS

**DRG. NO.:-** 01

**NORTH :**

**Deal by:**

**R 1**

**ATTIK ARCHITECTS**  
This drawing is the property of Attik Architects, no part of this may be reproduced or implemented in any form without prior permission in writing from Attik Architects. Any copies drawn on digital or hard to control protection and cost liable for damages.