

OPTION-03

NOTE

- HALF HT PARTITION
- 7' HT PARTITION
- GLAZED FULL HT PARTITION
- SOLID FULL HT PARTITION

CARPET AREA BRANCH
 =1592.00 SQ.FT. (Approximate)
ATM CARPET AREA
 =65.00 SQ.FT. (Approximate)
TOTAL CARPET AREA BRANCH & ATM=1657.00 SQ.FT. (APPROXIMATE)

CANARA BANK
 AT RAJAUJI BRANCH

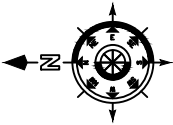

PROJECT:-

PROPOSED INTERIOR LAYOUT OF
CANARA BANK
 AT RAJAUJI BRANCH

REVISION:-

NO	DATE
REV-01	21/08/2025

Sheet title :-
FURNITURE LAYOUT PLAN

Scale :-	Date :-	Drawn by :-	Checked by :-
N.T.S	12/08/2025	Aditya Kumar	Ar. Amit Kumar

ARCHITECT :-

ARTCON DESIGN CONSULTANTS
 ARCHITECTS ENGINEERS
 INTERIOR DESIGNERS COMPUTER AIDED DESIGN
 G-04 Laxmi Palace, Mitra Compound, Boring Road, Patna - 800001
 +91 9991723771, amikumar73@gmail.com
 +91 9386717726 artcondesignconsultants.com

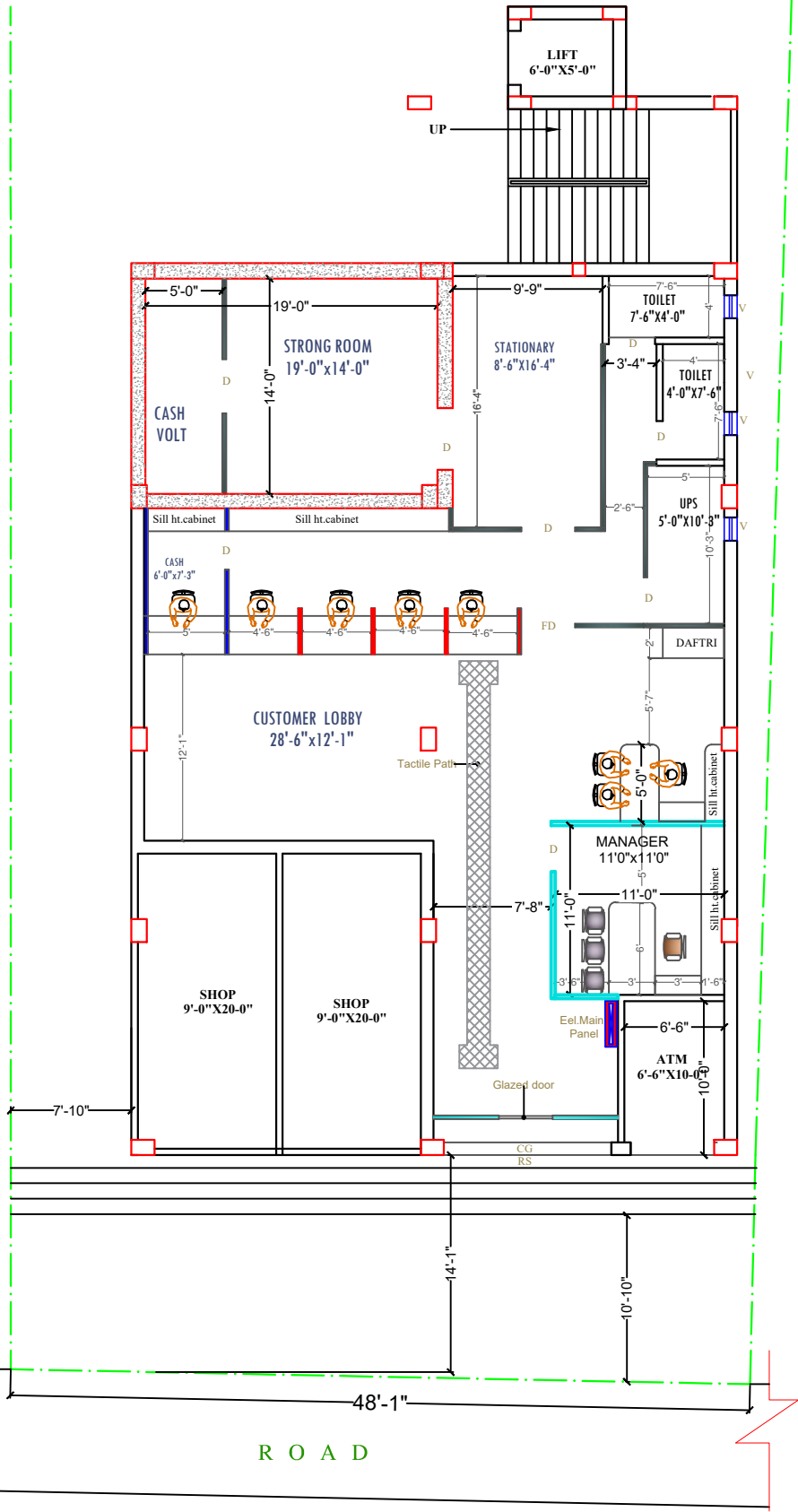

GROUND FLOOR PLAN