

FURNISHING WORKS IN NEW PREMISES OF BALLARY CANTONMENT BRANCH (BALLARY RO)

Location of the Branch/Office	Canara Bank, BALLARY CANTONMENT Branch
Eligibility of the contractor	Eligible Furnishing Contractors Empaneled with Circle Office: Hubballi
EMD	Exempted for Contractors Empaneled with Circle Office: Hubballi
Address for submission of sealed tenders	Circle Office: Hubballi
Last date & time for submission of sealed tenders	02.08.2025 up to 3:30 pm
Date & Time of opening of sealed tenders	02.08.2025 up to 4:00 pm
Payment terms	As per IBA norms.
Time limit for execution of work	30 days from the date of work order
Defect liability period	12 months after completion of work
Retention money towards defect liability period	3 % of final bill amount
Date of commencement of work	As per work order
Income Tax &/ other taxes	At applicable rate
Payment	After the completion of the work, as per procedure
Period for submitting final bill by contractor	Within one month from the date of virtual completion of the work
Liquidated damage for non-completion of work in time	1% OF THE TENDERED AMOUNT per week and part thereof for the delayed period maximum of 10%.
Rates quoted by bidder	I. The quoted rate should be inclusive of Cost of materials, transport, loading , unloading charges, cost of installation, all taxes (excluding GST), wastages, machinery, temporary works such as scaffolding, cleaning, overheads, profit, statutory expenses, incidental charges and all related expenses required for the completion of the work. II. Additional claims other than the quoted amount will not be entertained. III. The quoted rates shall be firm throughout the completion of the project
Insurance	Falls under scope of contractor.
Validity of submitted tender	90 days from the opening of tenders

The sealed tender must be dropped in tender box kept at the Circle Office within the above stipulated time. Tenderers / authorized representative are requested to be present at the time of opening. Canara Bank will not be bound to accept the lowest tender & reserves the right to reject any or all the tenders without assigning any reason thereof.

Signature of Bidder with seal

Premises & Estate Section,
Circle Office Hubballi
Centrum Building,

Internal

Page 1 of 20

NIT Ref. COHUB: GA: 006: DPJ:1425: 25-26 dated 25.07.2025

To

The Assistant General Manager,
P & E Section,
Canara Bank Circle Office,
Hubballi - 580030.

Dear Sir,

Sub: Furnishing works in the premises of BALLARY CANTONMENT Branch.

I/We hereby declare that I/ We have carefully gone through the conditions laid down in the Notice Inviting Tender, General notes, General Conditions of Contract, Special conditions, Schedule of approximate quantities and rates, Form of Agreement, General Specification, Approved manufacturers/natural source of materials Technical Specifications of schedule of quantities, and clearly understood all the same and on the basis of the same I/ We have quoted our rates in the Schedule of Quantities(i.e. BOQ) attached with the tender documents.

I / We have enclosed herewith a Demand Draft of _____Bank & No. _____ dated _____ favoring **Premises & Estate Section, Circle Office, Canara Bank, Hubballi** for ₹ _____ payable at Hubballi, towards E.M.D.

In the event of this Tender being accepted I/ We agree to enter into the agreement and submit the declaration on requisite non-judicial stamp papers as and when required and execute the contract according to your form of Agreement etc., in default whereof, I/ We do hereby bind my-self / ourselves to forfeit the aforesaid deposit.

I / We further agree to complete the work included in the said schedule of quantities within specified time from the date of the work order issued to commence the same.

I / We agree to pay all taxes(except GST), insurance charges as prevailing from time to time, on such items for whom same is to be levied by/ for the government, and the rates quoted by me / us are inclusive of all the same.

Once again knowing full well the contents of this tender, I / We sign this tender on this _____ Day of _____ month of 2023.

Signature of the Contractor with seal & date

Signature of Bidder with seal

Premises & Estate Section,
Circle Office Hubballi
Centrum Building,

T: 08362-2239432/433 /434

Gokul Road, Hubballi-580030

E:pecohub@canarabank.com

Internal

Page 2 of 20

SPECIAL CONDITIONS & INSTRUCTIONS FOR THE GUIDANCE OF TENDERER

1. The works at the branch/Office premises need to be executed duly taking care of the local bye laws/regulations of the local authorities like Police Dept, Water supply and Sanitary Board, Electricity Board, Central/ State Labor Commission etc. Necessary permissions, licenses, temporary connections if needed shall be obtained by the Contractor and Bank shall not be held responsible for any lapses.
2. The works shall be executed duly taking care of all safety measures and Bank shall be fully indemnified for any 3rd party claims, casualties, mishaps, loss of property etc. related to the undertaking & the execution of the subject work.
3. GST TAXES: As per the new Goods & Services Tax (GST) structure, the tenderers are required to have GSTIN number & Tenderers without GSTIN number are not eligible to participate in the tender process. The details as per the Annexure I attached are to be mandatorily furnished along with the tender. The eligible tenderers are requested to quote the GST separately. The taxes will be deducted at source as per the statutory requirements. While raising the bill, it shall be mentioned as bill to Canara Bank and our Bank's GSTIN number to be mentioned.
4. CANARA BANK'S KARNATAKA STATE GSTIN NUMBER is 29AAACC6106GIZX.
5. Tenderers are requested to submit the EMD in the form of crossed Demand draft only on any of the nationalized Banks/State Bank Drawn in favor of Premises & Estate Section, Circle Office, Canara Bank, Hubballi, payable at Hubballi. Tender with EMD in any other forms shall be rejected.
6. Tenderers are expected to visit the site before quoting the rates and should satisfy themselves as to the nature and conditions of work facilities available etc.
7. The tenderers are required to examine the enclosed general plan, tender form and conditions mentioned in the tender.
8. The tenderers should quote the rates in the figures. The amount for each item should be worked out and the requisite totals shall be given. The total amount shall be written both in figures and words.
9. The rates quoted in the tender shall be for measured finished works and shall include all changes including cost of materials, transportation, freight charges etc. complete.
10. The work is to be completed within stipulated time.
11. The successful tenderers shall give all necessary personal attention to the work during the process of work and also until the expiry date of "Defects Liability Periods" which is 12 months after the date of completion of the work.
12. The bank reserves the right to reject any portion of the work or material, which is, found unsatisfactory not up to the standard.

Signature of Bidder with seal

Premises & Estate Section,
Circle Office Hubballi
Centrum Building,

Gokul Road, Hubballi-580030

E:pecohub@canarabank.com

Internal

Page 3 of 20

NIT Ref. COHUB: GA: 006: DPJ:1425: 25-26 dated 25.07.2025

13. A retention amount of 3% of the bill amount will be retained from the final bill and shall be paid to the successful tenderers after the defect's liability period is over and upon the certification of the engineer.
14. Income tax deduction at prevailing / appropriate rates will be retained from each running bill which will be certified by the income tax authorities and a receipt will be given to the contractors.

CONDITIONS OF CONTRACT

1. If any additions and alterations are found necessary, the tenderers will have to do the same within the tendered rates with the prior approval of the bank.
2. The contractor shall employ adequate labor to complete the work within the scheduled time and shall make his own arrangements for housing his materials etc.
3. The contractor shall have to make his own arrangements to house his labor and staff for their services.
4. All tendered rates shall include for the cost of materials, labor, supervision, tools, plant, transportation, contingencies, duties, breakages, wastages, sundries, scaffolding, etc. complete.
5. All instruction regarding the execution of the work shall be received from the officials through consultant/architect only. Any other instructions issued directly to the contractor by anyone else shall not be binding on the bank.
6. The bank shall have the power to omit or cancel any item of work without assigning any reason whatsoever and no claim for compensation for damage will be entertained for such omissions and cancellation.
7. The contractor shall maintain satisfactory progress of work as well as maintain a desired level of workmanship. If in the opinion of the bank the progress is unsatisfactory and / or the workmanship is unsatisfactory then the bank shall take possession of the work within 7 days to that effect. The bank shall then complete the entire work and rectify all the defects at the contractor's cost and consequences.
8. In case the bank is not satisfied with the quality of materials used by the contractors, they reserve the right to direct the contractor to procure such materials supplied from agencies they deem fit.
9. The contractor is to be responsible for clearing any, all dirt and rubbish and superfluous materials as they accumulate and everything unnecessary and to leave the premises in a clean and orderly condition on completion and fit for occupation. No extra payment shall be made for doing this.
10. Any work which is not approved by the bank shall have to be removed within 24 hours from the time of order and shall have to be redone by the contractor at his own cost and this cost will be borne by the contractor.
11. No deviation whatsoever for any reason will be permitted, however, if any deviation becomes necessary, the same should be brought to the immediate notice of the bank and written approval must be obtained for such deviation before proceeding with the execution of work.

Signature of Bidder with seal

Premises & Estate Section,
Circle Office Hubballi
Centrum Building,

Gokul Road, Hubballi-580030

E:pecohub@canarabank.com

Internal

Page 4 of 20

T: 08362-2239432/433 /434

NIT Ref. COHUB: GA: 006: DPJ:1425: 25-26 dated 25.07.2025

12. The bank has got the right to supply any materials required for the work and cost of materials so supplied will be deducted from the bills of the successful contractor.
13. The contactor shall be responsible for safe custody of his materials/materials issued to him by the bank till they are used for the work. He shall make his own arrangements for the safe custody and proper storage and preservation in sound condition till the same are actually used in the work.
14. The tenderers shall extended full co-operation to the other contactor /agencies like electrical, air conditioning, Fire & CCTV, LAN etc. who are also working for the same project and co-ordinate with them in finishing the awarded work within the stipulated time given.
15. The contactor shall have a competent supervisor on the site for all the time.
16. For any new item the rate will be fixed by the bank as per prevailing fair market rate and labor which will be binding on the contactor.
17. In case the brand of materials mentioned in the tender is not available in the market, the alternate brand shall be used only after prior written approval of the bank.
18. The contactor shall be given a single electrical connection at work site. Electrical charges for consumption by the contactor will be charged separately by the bank, contractors have to provide sub-meter.
19. The successful tenderers shall not anticipate any financial help from the bank in the form of adhoc payment / advance for mobilizing and for starting the work.
20. The contractor should strictly adhere to the specifications and make of the materials, mentioned in the annexure. Any deviation will summarily reject the items of the work and not qualify for payment.
21. The successful tenderers shall be ready to carry out works between non-banking hours and even at nights and holidays. The contractor should sign all the pages of the document and the same shall be submitted to us.

Acceptance of contractor for Labor laws

- The successful tenderers / Contractor shall carefully and diligently implement the provisions of the Contract Labor Act & Contract Labor Rules.
- The Bank shall be entitled to deduct from the Contract Consideration, any such amount which the Bank has to pay in accordance with the Contract Labor (Regulation & Abolition) Act 1971 and Workmen's Compensation Act, in the event of the Bank having to disburse compensation / effect any payment under the Contract Labor Acts / Rules.
- Please note that as per rule 81(1) of Contract Labor (R&A) Rules, 1971, it is mandatory on the part of the Contractor to the display the notice containing the following details at prominent place at the work site.
 - a) Rates of wages.
 - b) Hours of work.

Signature of Bidder with seal

Premises & Estate Section,
Circle Office Hubballi
Centrum Building,

Internal

Page 5 of 20

NIT Ref. COHUB: GA: 006: DPJ:1425: 25-26 dated 25.07.2025

- c) Wage periods.
- d) Dates of payment of wages.
- e) Names & addresses of the Labor Inspectors having jurisdiction &
- f) Date of payment of unpaid wages.

The notice containing the above details shall be displayed without fail at the work site.

1. The Contractor shall not engage any workmen for wages, less than the minimum wages prescribed under the notification issued by the Central Government.
2. The contractor should follow all labor laws/guidelines laid down by central /state government from time to time.
3. ABNORMALLY HIGH AND LOW RATED ITEMS :

For item rate tenders if, the rates quoted by the lowest bidder for certain items of the Bill of Quantities of the tender are found to be abnormally high or low in comparison to the market rate analysis of the item done by the Architects/Bank and or in comparison to Architect/Bank's method of working out market rate justification for the items, the same shall be governed as under in order to avoid financial loss to the Bank in the event of default of Bidders.

- i. For abnormally high rated items (AHR), the progressive payment shall be 80% (eighty percent) of the payment due to the Bidder against execution of the AHR item. The balance withheld 20% payment shall be released after 75% of total value of the original contract is complete in financial terms or this 20% withheld payment can be released to the Bidder on submission of an unconditional bank guarantee of equivalent amount in the proforma of Bank. Further deviation limit for AHR items shall be nil on plus side and Bank reserves the right to restrict, substitute or not execute the AHR items during execution. The decision of the Architect/Bank's Engineer in this regard shall be final and binding on the Bidder.
- ii. For abnormally low rated (ALR) items the Bidder shall submit Bank Guarantee of difference in total of amount of ALR item(s) and the total amount of corresponding items at market rate of the Architect/Bank. This bank guarantee shall be valid till completion of the project. In exceptional circumstances, the amount of Bank Guarantees (BG) may be reduced or BG released earlier than completion period if, in view of Architect/Bank's Engineer, all ALR items as provided in the contract are executed as per terms of contract and/or not required to be executed.

Notwithstanding what is contained in Para i) & ii) above, the provisions of Para (i) and (ii) shall not be applicable on tenders invited on percentage rate basis.

The decision of the Bank on identification/ marking of AHR and ALR item are final and binding on the Bidder. In case the Bidder do not agree for furnishing of Bank Guarantee as above towards ALR items, at the time of award of works, the EMD/Performance guarantee of the Bidder shall be forfeited and decision of Architect in this regard shall be final and binding on the Bidder.

CERTIFICATE

I / WE HAVE READ, FULLY UNDERSTOOD THE ABOVE-MENTIONED REGULATIONS OF LABOUR LAWS/GUIDELINES AND ACCEPT THE SAME IN TOTO. I ALSO UNDERTAKE TO FOLLOW ALL LABOUR LAWS/GUIDELINES LAID DOWN BY CENTRAL /STATE GOVERNMENT FROM TIME TO TIME & INDEMNIFY THE BANK AUTHORITIES.

Signature of Bidder with seal

Premises & Estate Section,
Circle Office Hubballi
Centrum Building,

T: 08362-2239432/433 /434

Gokul Road, Hubballi-580030

E:pecohub@canarabank.com

Internal

Page 6 of 20

ANNEXURE I (TO BE MANDATORILY FURNISHED)

1.	Name of the Contractor under the Contract Labor (Regulation and Abolition) Act, 1970 (37 of 1970) (if applicable)	
2.	LIN / PAN No	
3.	Email Id	
4.	Mobile No.	
5.	No. & date of Certificate of Registration/ License*	
6.	Name of Person in charge of work	
7.	LIN / PAN No. of the person in charge of work	
8.	Email Id of the person in charge of work	
9.	Mobile No. of the person in charge of work	

* Please strike off whichever is not applicable

APPROVED LIST OF MATERIALS

1	Wood: All wood must be well seasoned, free from knots, other defects, decay and defects due to handling and transportation. Wherever necessary provide with anti-termite treatment.	Sal wood/ Thali wood (imported)
2	Teak Wood	Old Burma Teak
3	Marine grade plywood (BWF PF bounded)	ISI marked, complying to BIS specifications UNIPLY/ KITPLY/ CENTURY PLY/ ARCHID PLY
4	MR grade commercial plywood 4mm/6mm/12mm/ 19mm/25mm sizes.	ISI marked, complying to BIS specifications UNIPLY/ KITPLY/ CENTURY PLY/ ARCHID PLY
5	Veneers	Anchor/Green Ply / Century / Euro
6	Laminate: Design , shade, finish as per Architect's Selection confirming to IS: 2046	Decolote- formica/ Marino/ mica Greenlam / Meriono / Euro
7	Powder coated track, ceiling	Interarch, Vista – levotor, Luxalon
8	Hinges, tower bolts, handles	Brass oxidized/ epoxy powder coated (heavy duty)
9	Glass, Float Glass	Saint-Gobain / Modiguard / Asahi
10	Adhesive materials	Fevicol (pidilite make)
11	Powder coated aluminum partitions (15.20 micron two step electrical color process using polyester powder)	Jindal / Indal/ Hindal (Heavy Gauge 1.2 mm th, 15.20 micron 2 Step thick electrical color process Using polyester powder)
12	Pre laminated boards confirming to IS: 12823: 1990	Novopon /Eco board (Exterior grade only)
13	Floor springs confirming to IS: 6315/ door closure confirming to IS: 3564	OZONE/ HAFELE

Signature of Bidder with seal

Premises & Estate Section,
Circle Office Hubballi
Centrum Building,

Internal

Page 7 of 20

14	Fixtures	All hardware fittings & fixture are to be powder coated. Color, finish as per Bank's specification, Godrej makes.
15	Melamine Polish	Asian Paint / ICI / Nerolac
16	External Emulsion (Anti-flasking, Anti-fungal)	Asian (Ace)/ Nerolac/ Berger/Dulux Sample to be approved by the Architect.
17	Oil Bound Distemper	Asian / Nerolac/Berger/Dulux Sample to be approved by the Architect.
18	Synthetic Enamel Paint	Asian /Nerolac/Berger/Dulux. Sample to be approved by the Architect.
19	Automobile Duco paint	MRF / ICI / Asian
20	Carpet Tiles	Nylon carpet tile -shaw/Milliken/Bentley prince
21	Cement	ACC, UltraTech, Ambuja - 43 grade
22	Bricks	Burnt bricks with minimum strength of 35KG/Cm ²
23	Hinges / drawers	Earl-Bihari Pvt Ltd, Godrej
24	Steel	HYSD bars with FE-415 grade
25	Vitrified tiles	Naveen / RAK / Nitco / Kajaria
26	Ceramic Tiles	H & R Johnson/Bell/Kajaria/Naveen /Spartek.
27	Glazed Tiles	H & R Johnson/Bell/Kajaria /Spartek/ Naveen
28	Tiles fixing adhesive	Algitile / Balgrout.
29	False Ceiling tiles	Armstrong or equivalent only
30	Italian Marble	Classic / Nitco / Elegance
31	Vertical / roller blinds	Hunter Douglas, Mac, Vista, Technifab
32	Wall paper	Marshall / ego / softek
33	Glass film	GARWARE OR EQUIVALENT
34	Drawers / cupboards Locks	Godrej / Yale / Hafele / Dorma Laxmi Make
35	Door Locks	SS finished Mortice lock of Laxmi make
36	PVC Pipes	Finolex /Prince
37	M.S.Pipes	Tata
38	Sanitary Ware	Parry ware /Hindustan sanitary
39	Granite slab 20 mm thick	Edges shall be rounded. Beveled.
40	Vinyl flooring (2mm thick)	Royal House
41	Door closure	Everite/ Godrej/ Hafele
42	Steel	Kamadhenu

Note: Samples are to be approved by Bank and Architect if any. Any brands indicated under the items specifications in the Bill of quantities will prevail over the above indicated makes.

Signature of Bidder with seal

Premises & Estate Section,
Circle Office Hubballi
Centrum Building,

Internal

Page 8 of 20

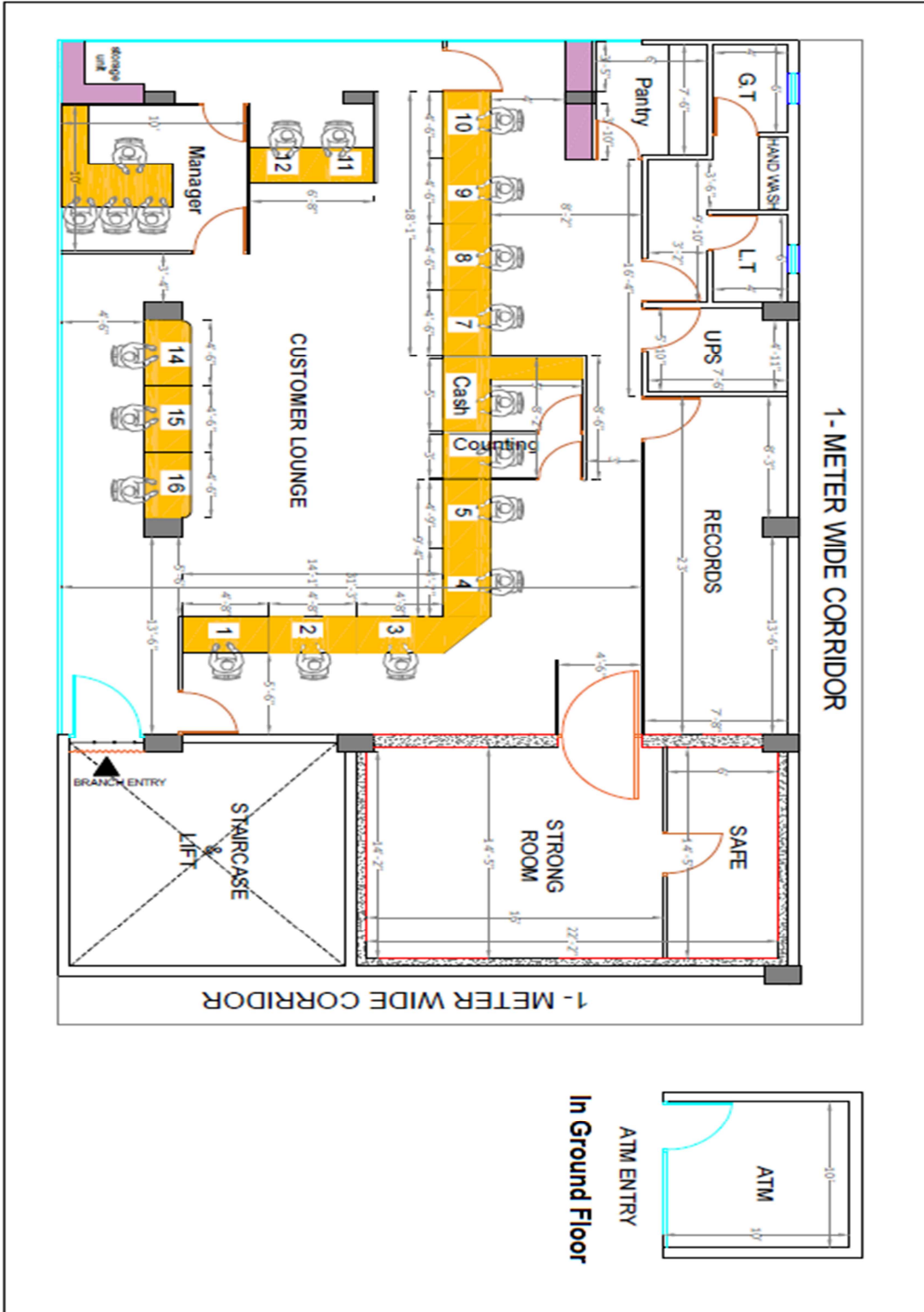

Signature of Bidder with seal

Premises & Estate Section,
Circle Office Hubballi
Centrum Building,

T: 08362-2239432/433 /434

Gokul Road, Hubballi-580030

E:pecohub@canarabank.com

Internal

Sl. No.	DESCRIPTION OF ITEM	QTY	UNIT	RATE in Rs	AMOUNT in Rs
1	BRANCH ENTRANCE PARTITION WITH DOOR				
	Providing and fixing glazed aluminum framed partition with two door shutters by using 101.6 x 44.4mm-2.1mm thick extruded aluminum sections for the verticals at a spacing of 3ft c/c and 3 horizontals in fixed portion and 2 horizontals in the door opening. The door shutters shall be of 7x3 ft made of 47.62mm x 44.5mm - 1.8mm standard extruded aluminum door sections for the verticals, top, middle and 85 x 44.5mm- 1.8mm for the bottom. The partition & door shutter shall be covered by 8mm thick plain glass of Modi float / saint Gobain / asahi make and fixed with aluminum clipping channel. The glass shall be pasted with white frosted film as per approved design. The door shutters shall be fixed with Floor spring and pivot. There shall be 2 no's 15" long SS tubular handle and concealed door lock. All the aluminum sections shall be powder coated to approved shade.	42.00	Sft		
2	WOOD FRAMED PARTLY GLAZED PARTITION (MANAGER CABINS)				
	Providing and fixing of double skin partition using 45mm x 45mm (finished dimensions) SALWOOD sections treated with anti-termite oil for frame works with verticals at a maximum spacing of 2 ft. C/C and five horizontals at 0', 2', 7', false ceiling & true ceiling level. The corner verticals shall be common. The partition shall be covered by 6mm thick MR grade commercial plywood on both sides for the bottom and the top panel. The middle panel to be covered by 8mm thick plain glass fixed with 8mm thick beech wood beadings of necessary width. All the exposed surface of wood sections shall be covered by 6mm thick MR grade commercial grade plywood & finished with 1mm thick lamination of approved color. All the accessories used shall be of concealed type. The finishing for plywood shall be with 1mm thick lamination of approved shade on both sides. There shall be 4" height skirting in the top and bottom on both sides with 1mm lamination finish. Necessary openings for the door shall be provided which shall be finished with beach wood beadings. All the exposed wood / wooden beadings shall be neatly finished with 2 coats of wood polish & stained to required color. All the glass surfaces shall covered on one side as per the design by frosted film of approved make. The lamination shall be provided up to the false ceiling level. payable area shall be for the frame work excluding the door openings .	190.00	Sft		
3	UPS ROOM PARTITION- FULLY PANELLED				

Signature of Bidder with seal

Premises & Estate Section,
Circle Office Hubballi
Centrum Building,

Internal

Page 10 of 20

ಸಿಂಡಿಕೇಟ್ ಸಿಡಿಕೇಟ್ Syndicate

NIT Ref. COHUB: GA: 006: DPJ:1425: 25-26 dated 25.07.2025

	Providing and fixing double skin partition using 45mm x 45mm (finished dimensions) SALWOOD sections treated with anti-termite oil for frame works with verticals at a maximum spacing of 2 ft. c/c in both directions. The corner verticals shall be common. The partition shall be covered by 6mm MR grade commercial thick plywood on one side and 12mm thick cement bonded particle board on the other side (UPS side) . The finishing shall be with 1mm thick lamination of approved shade on ply wood side and 2 coats of plastic emulsion painting on cement board. All the exposed wood / wooden beadings shall be neatly finished with 2 coats of wood polish & stained to required color. There shall be a 4" height skirting in the top and bottom on lamination finish side .Necessary openings for the door shall be provided which shall be finished with beach wood beadings. The lamination shall be provided up to the false ceiling level. payable area shall be for the frame work excluding the door openings.	573.00	Sft		
4	DOOR FOR PARTITIONS - PARTLY GLAZED				
	Providing and fixing door of size 3' X 7' (W X H) using 30mm thick water proof flush door shutters with all-round beach wood beading. An opening of 24"x 40" shall be provided. The door shall be finished with 1mm thick lamination of approved shade except for the opening. The opening shall be covered by 8mm thick plain glass fixed with necessary beech wood beadings. All the exposed wood / wooden beadings shall be neatly finished with 2 coats of wood polish & stained to required color. All the glass surfaces shall covered on one side as per the design by frosted film of approved make. All the accessories used shall be of concealed type. There shall be 4" height skirting in the bottom with 1mm lamination finish of approved shade . Each door to be fixed to the partition using 5" length stainless steel hinges - 3 Nos and provided with 1 No.of mortice lock, 2 Nos SS tubular handles, 1 No door closure and door stopper.	7.00	No		
5	CASH CABIN FRONT & COUNTER TOP PARTITION				
	Providing and fixing partition for cash cabin front by using 45mm x 45mm (finished dimensions) SALWOOD sections treated with anti-termite oil for the frame work. There shall be at least three horizontals at 0'0", 0'8" and 3'6" levels [approx.] from the customer counter top level (which will be at 3'6" height from floor level) and two verticals at the ends. The corner verticals shall be common. The exposed surface of wood shall be covered by 6mm thick MR grade commercial grade plywood & finished with 1mm thick lamination of approved shade. The bottom 0'8" height panel to be covered by 7.5 mm thick 56mm x 47mm opening aluminum grill (AL 101) fixed with suitable beach wood corner beadings. At the mid portion of the panel there shall be an opening of 6" x 6" with all-round wood frame work & this opening shall	82.00	SFT		

Signature of Bidder with seal

Premises & Estate Section,
Circle Office Hubballi
Centrum Building,

Internal

Page 11 of 20

ಸಿಂಡಿಕೇಟ್ ಸಿಡಿಕೇಟ್ Syndicate

NIT Ref. COHUB: GA: 006: DPJ:1425: 25-26 dated 25.07.2025

	have a sliding or openable type shutter with locking arrangement from inside to facilitate cash receiving/ paying. The top panel shall be covered by two glass panels made of 12 mm thick plain glass fixed with 8mm thick beech wood beadings of necessary width with an intermediate horizontal gap between two glass panels to facilitate communication between customer and cashier. All the glass surfaces shall covered on one side as per the design by frosted film of approved make. All the exposed wood / wooden beadings shall be neatly finished with 2 coats of wood polish & stained to required color.			
6	CASH CABIN SIDE & REAR PARTITION Providing and fixing partitions for cash cabin sides & rear areas by using 45mm x 45mm (finished dimensions) SALWOOD sections treated with anti-termite oil for the frame work. The verticals spaced at required intervals but not more than 3 feet c/c unless otherwise specified. The corner verticals shall be common. There shall be at least 4 horizontal wood sections at 0" 0', 2'0", 3'6" and 7'0" levels [approx.] from the floor level. The bottom 3'6" height panel to be covered by 6mm thick MR grade commercial plywood on both sides and finished with 1mm thick lamination of approved color. All the exposed surface of wood sections shall be covered by 6mm thick MR grade commercial grade plywood & finished with 1mm thick lamination of approved shade. The top panel shall be covered by 6mm thick plain glass panels in heights of 250mm with 50mm high slits and fixed with 8mm thick beech wood beadings of necessary width. All the glass surfaces shall covered on one side as per the design by frosted film of approved make. All the exposed wood / wooden beadings shall be neatly finished with 2 coats of wood polish & stained to required color. There shall be a horizontal tray at 3 ft level to facilitate slips movement and communication between supervisor and cashier.	118.00	SFT	
7	DOOR FOR BULK CASH CABIN - PARTLY GLAZED Providing and fixing door of size 2'6" X 7' (W X H) using 30mm thick water proof flush door shutters with all-round beach wood beading. An opening of 18"x 40" shall be provided. The door shall be finished with 1mm thick lamination of approved shade except for the opening. The opening shall be covered by 8mm thick plain glass fixed with necessary beech wood beadings. All the exposed wood / wooden beadings shall be neatly finished with 2 coats of wood polish & stained to required color. All the glass surfaces shall covered on one side as per the design by frosted film of approved make. All the accessories used shall be of concealed type. There shall be 4" height skirting in the bottom with 1mm lamination finish. The door shutter shall be fixed with 3 no's stainless steel (SS) make 5" size hinges, one number 6	2.00	No	

Signature of Bidder with seal

Premises & Estate Section,
Circle Office Hubballi
Centrum Building,

Internal

Page 12 of 20

NIT Ref. COHUB: GA: 006: DPJ:1425: 25-26 dated 25.07.2025

	levered Godrej make (with minimum 3 keys) automatic NIGHT LATCH fixed just below 3 feet level and one 3" long SS material tower bolt and 4" long SS material handles on both the sides.			
8	ALUMINIUM GRILL FOR BULK CASH COUNTER TOP			
	Providing & fixing 7.5mm thick 48mm X 48mm opening white color powder coated aluminum grill (AL 101) at the top of the cash cabin fixed with 8mm thick beech wood beadings of necessary width. All the exposed wood / wooden beadings shall be neatly finished with 2 coats of wood polish & stained to required color. All the accessories used shall be concealed type. All the aluminum sections shall be white color powder coated.	70.00	Sft	
9	BULK CASH COUNTER WITH GLASS TOP			
	Providing and fixing Bulk cash counter of following specifications :			
	The counter shall be of length 72", height 42", working top width of 30",customer top width of 12" with front panel, side vertical support, intermediate support using 19mm thick BWP block board. There shall be three draws of size 15" X 22" X 6" (internal dimensions) and cupboard with shutter at bottom on the right-hand side of the counter fixed in between the intermediate support and main support. The draw shall be made of 19mm thick BWP block board for all the sides and 6mm MR grade commercial plywood for the bottom. The drawers to be provided with metallic sliding channels with rollers of approved make for easy push and pull. draw bottom Partitions for denomination to be provided using 10mm plywood in first drawer. The working top, customer top, front panel, front face of shutter and draws shall be finished with 1mm thick lamination of approved shade. The front elevation of the counter shall be using 6mm thick MDF to provide recession and finished with Beach wood beadings, 1mm laminate finish.			
	The customer top & working top shall be provided with 10mm thick plain glass with edges beveled & polished. There shall be shelf of size 10" X 20" below the working top on left hand side for CPU UNIT using 19mm thick BWP block board. A foot rest of size 3" X 1 ½" hardwood section shall be provided. All the exposed edges shall be provided with beach wood beadings of size 19mm x 6 mm and finished with wood polish. All non-laminated exposed surfaces except beadings shall be provided with two coats of enamel paint over a coat of primer. Each draw shall have one multipurpose concealed lock, stainless steel handle and SS hinges for the shutter. Necessary openings for the access of the wires and plugs with wire manager to be provided with PVC caps for the counter top at appropriate location.	1.00	No	
10	RUNNING LOW COUNTER			

Signature of Bidder with seal

Premises & Estate Section,
Circle Office Hubballi
Centrum Building,

Internal

Page 13 of 20

	Providing and fixing Running Low counter of following specifications :			
	Providing and fixing Running customer counter of following length and height 30" and working top width of 30" width (all minimum dimensions) all as per drawing with front, working top, main vertical support up to the working top at every 5ft c/c and intermediate vertical support for draw unit up to working top. The working top shall be at a height of 30". There shall be two drawers of size 13"x 22"x 5" (internal dimensions) fixed in between the intermediate support and main support at every 5ft c/c. The portion below the drawers shall have a cupboard with front shutter. The counter and the drawers shall be made by using 19mm thick BWP block board except for draw bottom which shall be provided with 12 mm MR grade commercial plywood. The front elevation of the counter shall be as per the design detailed in the drawing using 6mm thick design teak wood/ MDF board to provide recession and finished with 1mm laminate. The customer top, working top, customer front & front face of shutter and draw shall be finished with 1 mm thick lamination of approved shade .			
	For every seating area (normally 4'6" to 5 feet length) there shall be a foot rest made of 3" x 2" hardwood section with proper painting finish. The drawer's movement shall be with metal sliding channels with rollers. All the exposed edges shall be provided with beach wood beadings of size 19mm x 6mm and neatly polished. The non-laminated surfaces except beadings shall be finished with two coats of enamel paint over a coat of primer. Each drawer/cupboard shall have one multipurpose concealed lock and 3" long brass or stainless-steel handle. Necessary openings for the access of the wires with plug shall be provided with PVC caps with silver tone for the counter top at appropriate location.(any change in the length shall be paid proportionately)	6.66	Rft	
11	FRONT GLASS FOR SINGLE WINDOW COUNTER			
	Providing and fixing 12mm thick plain glass of height varying between 1' 6" & 1' 0" for the front of the single window counters above the customer top. The vertical supports shall be from the main side partition and fixed with 8mm thick beech wood beadings of necessary width. An opening of size 5" X 5" is to be provided in the 1'6" glass above the customer top for cash / slip transaction with necessary lockable glass shutter . There shall be 2"/3" gap between the glasses counter top for easy communication with the customer. The exposed edges of the glass shall be beveled, grinded and machine finished to render smooth edges. All the exposed wood / wooden beadings shall be neatly finished with 2 coats of	228.00	Sft	

Signature of Bidder with seal

Premises & Estate Section,
Circle Office Hubballi
Centrum Building,

Internal

Page 14 of 20

ಸಿಂಡಿಕೇಟ್ ಸಿಡಿಕೇಟ್ Syndicate

NIT Ref. COHUB: GA: 006: DPJ:1425: 25-26 dated 25.07.2025

	wood polish & stained to required color. All the glass surfaces shall covered on one side as per the design by frosted film of approved make.			
12	TABLES WITH GLASS TOP			
	Providing and fixing Tables of following sizes with front, working top and side vertical support, intermediate vertical support . There shall be three draws of size 15" X 22" X 5" fixed in all-round boxing with top, side vertical, intermediate supports of the table as common side & top. The table & draws shall be made by all by using 19mm thick BWP block board except for the draw bottom which shall be with 6mm MR grade commercial ply wood. The draw shall be fixed with metal slider channels with rollers for easy push and pull. The front elevation of the table shall be as per the design using 6mm thick MDF to provide recession and finished with beach beadings. The working top, sides, front, front face of draw shall be finished with 1mm thick lamination. The working top shall be provided with 10mm thick clear glass with edges beveled and machine finished to render smooth edges. Each draw shall have stainless steel handle with individual locks .			
	There shall be shelf of size 10" X 20" below the working top for the CPU UNIT using 19mm thick MR grade block board. A foot rest of 3" X 1 1/2" hardwood section shall be provided. All the exposed edges shall be provided with beach wood beadings of size 19mm x 6 mm and finished with wood polish. All non-laminated exposed surfaces except beadings shall be provided with two coats of enamel paint over a coat of primer. Each draw shall have one multipurpose concealed lock, stainless steel handle and SS hinges for the shutter. Necessary openings for the access of the wires and plugs with wire manager to be provided with PVC caps for the counter top at appropriate location.			
	Chief Manager Table of 3' 0" (W) x 6' 0" (L) x 2' 6" (H)	1.00	No	
	officer Table of 2' 6" (W) x 4' 6" (L) x 2' 6" (H)		No	
13	SIDE CUPBOARD			
	Providing and supplying SIDE cupboard of size 3' 6"(L) X 2' 6" (H) X 1' 6" (W) with top, sides, bottom, draws and front swinging shutters all by using 19mm BWP block board except for the rear portion & draw bottom which shall be covered by 6mm MR grade commercial plywood. There shall be two draws of size 17" X 16" X 5" (all internal dimension). The front, side, rear & top shall be finished with 1mm lamination. The draws shall have sliding arrangement using metal slider channels with rollers for easy push and pull. There shall be skirting of height 3". All the exposed edges shall be provided with beach wood beadings of size 19mm x 6 mm and finished with wood polish. All non-laminated exposed surfaces	1.00	Nos	

Signature of Bidder with seal

Premises & Estate Section,
Circle Office Hubballi
Centrum Building,

Internal

Page 15 of 20

NIT Ref. COHUB: GA: 006: DPJ:1425: 25-26 dated 25.07.2025

	except beadings shall be provided with two coats of enamel paint over a coat of primer. The swinging shutters shall be fixed using SS hinges. There shall be 4 nos of SS handles , 3 no's multipurpose concealed for the entire unit. Any minor variation in the size shall be payable on proportionate volumetric basis.			
14	RUNNING STORAGE CUPBOARDS (SWING SHUTTERS)			
	Providing and supplying running storage cupboards of width 18" and height 36" or up to the specified height as per site conditions with top, sides, verticals at every 3ft C/C, horizontal shelves at 1.5 ft C/C or part thereof. The storage unit's verticals, horizontals & front swing shutters all shall be made by using 19mm BWP block board and only rear side covered by 6 mm Mr grade commercial ply wood. The front shutters may be of size 18" to 21" width. There shall be skirting of height 2" to 3". All the visible surfaces like front, top and sides shall be finished with 1mm thick lamination. All the exposed edges shall be provided with beach wood beadings of size 19mm x 6 mm and finished with wood polish. All non-laminated exposed surfaces except beadings shall be provided with two coats of enamel paint over a coat of primer. There shall be one number of multi-purpose lock for every two shutters. Each shutter shall have a stainless-steel handle, a brass ball catch/ aluminum powder tower bolt 3" size as the case may be. The payment shall be based on the elevation area of storage units .	475.00	SFT	
15	SHELFS / LEDGES/ FLAP DOORS			
	Providing and fixing Shelves/ Ledges/ Flap doors in all horizontal/ vertical surfaces in areas not exceeding 10sqft using 19mm thick MR grade Block board and finished with 1mm lamination on one side. All the exposed edges shall be provided with beach wood beadings of size 19mm x 6 mm and finished with wood polish. All non-laminated exposed surfaces except beadings shall be provided with two coats of enamel paint over a coat of primer. The Shelves/ Ledges/ Flap doors shall be fixed to the partitions / counters/ cupboards by SS hinges and beach wood beadings for the stoppers.	27.00	Sft	
16	WOOD FRAMED FULL HEIGHT WALL PANELLING			
	Providing & fixing wall paneling using 50mmx 25mm SALWOOD sections treated with anti-termite oil for the frame work spaced at 2 ft ' C/C and cladded with 8mm thick MR grade commercial plywood and finished with 1mm thick lamination finish of approved shade. The soffits of the windows shall also be covered with paneling.(Wall paneling shall not be provided behind storages)	606.00	Sft	
17	MINERAL FIBRE BOARD GRID TYPE FALSE CEILING			

Signature of Bidder with seal

Premises & Estate Section,
Circle Office Hubballi
Centrum Building,

Internal

Page 16 of 20

ಸಿಂಡಿಕೇಟ್ ಸಿಡಿಕೇಟ್ Syndicate

NIT Ref. COHUB: GA: 006: DPJ:1425: 25-26 dated 25.07.2025

<p>Providing, fabricating, erecting lay-in type tegular/ drop type Mineral fiber board false Ceiling of 600mm x 600mm grid as per the following specifications. The approved brands are ARMSTRONG/ NITTOBO / SAINT GOBAIN. The following specifications are the minimum and tenderers may quote for the equivalent or better specification.</p>	1,021.00	Sft		
<p>The grid system having 600mm x 600 mm or part thereof wherever necessary, shall be made using hot dipped galvanized steel section, exposed surface chemically cleaned capping prefinished in backed polyester paint, main Tee of size 14 x 38 x 0.33mm at every 1200mm c/c max and rotary stitched cross tee of size 14 x 38 x 0.33mm at every 600mm c/c and cross Tee of size 14x 38 x 0.33mm at every 1200 c/c max and 14 x 22 x 0.457mm wall angle all-round the wall to form grid size of 600 x 600mm. The suspension system shall have 4mm dia pre-straightened GI rods which are in-turn supported from real ceiling using 6mm size anchor bolts, connected with adjustable Hanger clips/ J bolts and other accessories as per the manufacturers specifications. The T Sections have a Galvanizing of 120 grams per M2 & passed through for 500 hrs. of Salt test.</p>				
<p>The tiles/ panels shall be of prima Fine Fissured Micro look tegular of ARMSTRONG or Fine Fissured High NRC(Narrow reveal) edge Tiles of Saint Gobain Mineral Fiber Acoustic Ceiling Tiles of size 600 x 600 x 18 mm thick over the formed grid, in module size of 600mm x 600mm x 18mm Thick.</p>				
<p>The item shall include the cost of additional Tee or L supports & other accessories near the ends/ odd size edges/corners, making necessary openings for electrical light fittings, fire alarm detectors and any other fixtures. No extra payment shall be made for making openings in the panels/ grid for the purpose of light fittings. Item rate shall include all the taxes, transportation, erection, loading & unloading and any other incidental expenditure that may be required to be spent in completing the work in totality as per above specifications. The tiles removed to place light fittings shall be handed over to bank's custody and there may not be any deduction for light fittings area.</p>				
<p>18 GYPBOARD CEILING</p>				
<p>Providing and fixing suspended false ceiling, which includes providing and fixing GI perimeter channels of size 0.55mm thick having one flange of 20mm and another flange of 30mm and a web of 27mm along with perimeter of ceiling, screw fixed to brick wall/partition with the help of nylon sleeves and screws at 610mm centers. The suspending GI intermediate channel of size 45mm, 0.9mm thick with two flanges of 15mm each from the soffit at 1220mm centers with ceiling angle of width</p>	750.00	Sft		

Signature of Bidder with seal

Premises & Estate Section,
Circle Office Hubballi
Centrum Building,

Internal

Page 17 of 20

ಸಿಂಡಿಕೇಟ್ ಸಿಡಿಕೇಟ್ Syndicate

NIT Ref. COHUB: GA: 006: DPJ:1425: 25-26 dated 25.07.2025

	25mmx 10mmx 0.55mm thick fixed to soffit with GI cleat and steel expansion fastened. Ceiling section of 0.55mm thickness having knurled web of 51.5mm and two flanges of 26mm each with lips of 10.5mm are then fixed to the intermediate channel with the help of connecting clips and in direction perpendicular to the intermediate channel at 457mm centers. 12.5mm tapered edge Gypboard (Conforming to IS- 2095-1982) is then screwed fixed to ceiling section with 25mm dry wall screw at 230mm centers. Screw fixing is done mechanically.			
	Finally the boards are to be jointed and finished so as to have a flush look which includes filling as finishing the tapered and square edge of the boards with joining compound, paper tape and two coats of primer suitable for Gypboard (as equivalent) extra frame work for electrical fittings, A/C diffusers, and/or any other cutout, trap doors, wooden shadow battens (hollock wood black enamel painted-25x40mm) at wall peripheries and ends, 12mm thick MDF board for pelmet etc. complete including opening to be made for AC grills, light fittings, trap doors etc. (The quoted rate shall be inclusive of suspenders at all heights) (The rate to be quoted including plastic emulsion paint)			
19	KEY BOARD TRAY			
	Providing and fixing of readymade Key Board tray of approved make size 20" length (minimum) made of metal sheet and finishing with powder coating. The Key board shall be fixed to different items like counters, tables.	16.00	No	
20	LOGO BOARDS FOR COUNTER ELEVATION			
	Supplying and fixing logo boards on the front laminated surface of counters with 5mm thick acrylic sheet of size 33" x 15", attached with SS glass studs (1" or more). Stickers with blue background and bank logo in the center to be pasted on the back side of the acrylic sheet neatly without any bubbles.	16.00	No	
21	CUSTOMER WRITING DESK.			
	Supplying and fixing free standing customer writing desk of 36" length, 42" height and 18" deep with top, front, side supports and foot rest. There shall be bins of size 6" x6" (front opening) for keeping challans at the top level, all made out of 19mm thick BWP Block board. The top, front and side surfaces laminated with 1mm lamination. All the exposed edges shall be provided with beach wood beadings of size 19mm x 6 mm. All the non-laminated surfaces and wood beadings shall be neatly polished with wood polish over a coat of primer. The top shall be provided with 10 mm clear glass edge beveled fixed with 6 SS studs.	1.00	No	
22	SUGGESTION BOX			

Signature of Bidder with seal

Premises & Estate Section,
Circle Office Hubballi
Centrum Building,

Internal

Page 18 of 20

ಸಿಂಡಿಕೇಟ್ ಸಿಡಿಕೇಟ್ Syndicate

NIT Ref. COHUB: GA: 006: DPJ:1425: 25-26 dated 25.07.2025

	Supplying and fixing Suggestion Box with front opening with door & lock, slot for dropping letters from top, all made out of 12mm MR grade commercial ply wood. The top, front and side surfaces laminated with 1mm lamination. All the exposed edges shall be provided with beach wood beadings of size 19mm x 6 mm. All the non-laminated surfaces and wood beadings shall be neatly polished with wood polish over a coat of primer. The overall size shall be 8" x 10" x 12" (D X W X H).	1.00	No		
23	CHEQUE DROP BOX				
	Supplying and fixing Cheque Drop Box with front opening with door & lock, slot for dropping cheques from top, all made out of 12mm MR grade commercial plywood. The front door shall have 6mm glass 6"x 12" fixed with beach wood beading. The top, front and side surfaces laminated with 1mm lamination. All the exposed edges shall be provided with beach wood beadings of size 19mm x 6 mm. All the non-laminated surfaces and wood beadings shall be neatly polished with wood polish over a coat of primer. The overall size shall be 10" x 12" x 20" (D X W X H)	1.00	No		
24	NOTICE BOARD				
	Providing and fixing notice board of size 4' X 3' by using 19mm thick BWP Block board with 1 ½" X ½" beach wood beading all-round. The inside surface shall be provided with 12mm thick soft board with fabric on the top. The beach wood beading shall be provided with two coats of polish over a coat of primer.	2.00	No		
25	GLASS DISPLAYS				
	Providing and fixing 8mm thick glass panes of required sizes (each display not exceeding an area of 10 Sft) with all edges neatly grinded & polished and fixed to the wall surfaces using ' D' brackets / SS studs . The glass shall be plain glass of Modi, saint Gobain, asahi make.	10.00	SFT		
26	GLASS SHELFs				
	Providing and fixing glass panes of required sizes (each shelf not exceeding an area of 2 Sft) with all edges neatly grinded & polished and fixed to the wall surfaces using D brackets. The glass shall be 12mm thk plain glass of Modi, saint Gobain, asahi make.	10.00	SFT		
27	FLOOR MAT				
	Providing and supplying vinyl mat of size 3ft x 2 ft durotuff make	3.00	Nos		
28	TEXTURE PAINTING				
	Wet scrapping on existing surface with sand paper to remove old loose paint layers and providing & applying Plaster of Paris punning/ putty in two layers , followed by texture paint (Royal Play/ Berger Silk Illusions) with one base coat and 2 top coats with roller/spray after preparing the base for the same.	95.00	Sft		

Signature of Bidder with seal

Premises & Estate Section,
Circle Office Hubballi
Centrum Building,

Internal

Page 19 of 20

|| ಸಿಂಡಿಕೇಟ್ ಸಿಂಡಿಕೇಟ್ Syndicate ||

NIT Ref. COHUB: GA: 006: DPJ:1425: 25-26 dated 25.07.2025

29	ROLLER blinds				
	Providing and fixing of Luxaflex / MAC make or equivalent brand window ROLLER blinds with top aluminum channel frame with necessary rolling / folding arrangement.	648.00	Sft		
30	Removing old furniture's & counters including stacking the same as directed by the architect in charge of the work.		L.S.		
31	Temporary arrangement for the existing counter & tables as per the site conditions.		L.S.		
Total (Ex GST)					

Signature of Bidder with seal

Premises & Estate Section,
Circle Office Hubballi
Centrum Building,

Internal

Page 20 of 20