

PROPOSED LAYOUT PLAN

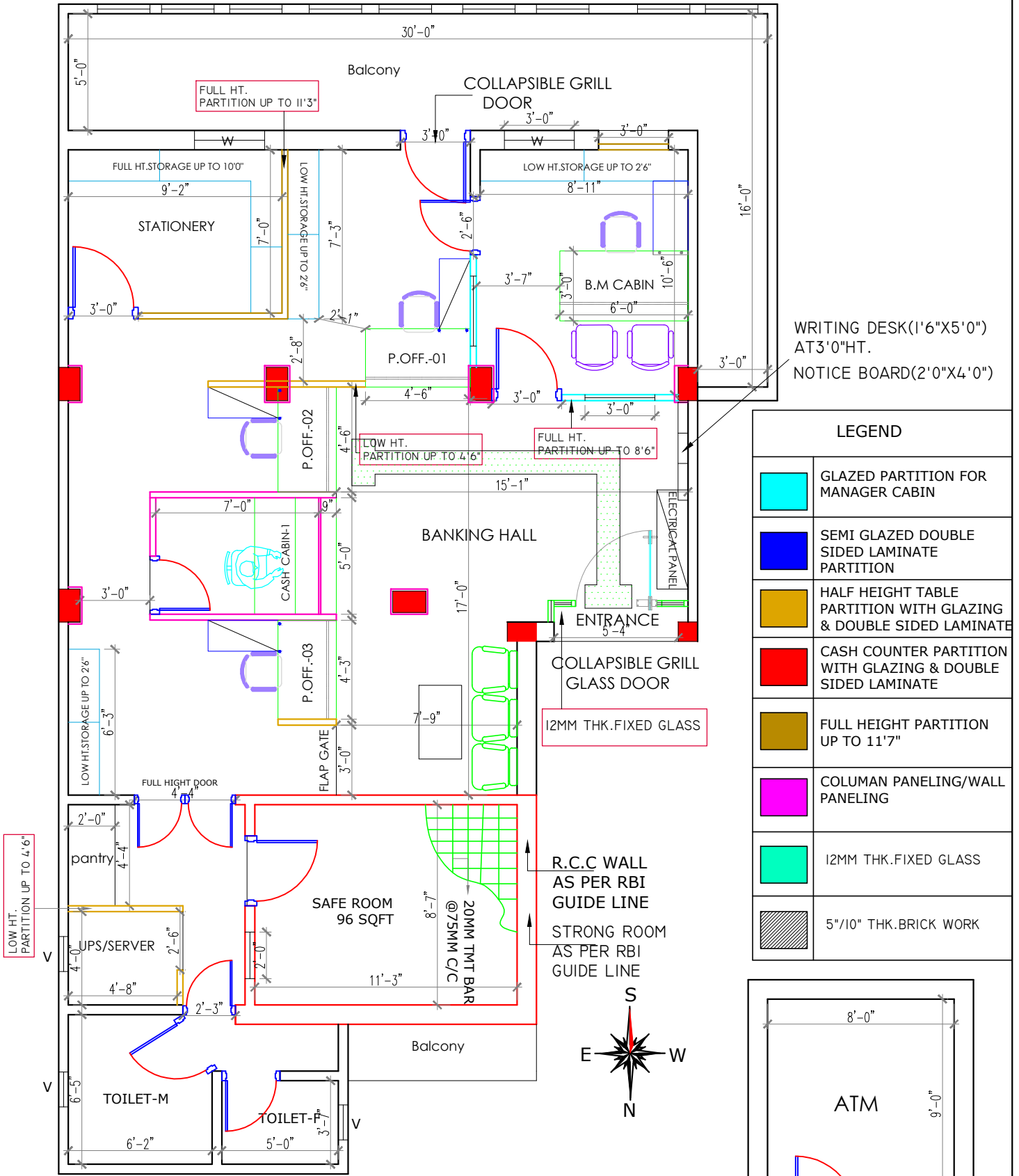

LEGEND	
	GLAZED PARTITION FOR MANAGER CABIN
	SEMI GLAZED DOUBLE SIDED LAMINATE PARTITION
	HALF HEIGHT TABLE PARTITION WITH GLAZING & DOUBLE SIDED LAMINATE
	CASH COUNTER PARTITION WITH GLAZING & DOUBLE SIDED LAMINATE
	FULL HEIGHT PARTITION UP TO 11'7"
	COLUMN PANELING/WALL PANELING
	12MM THK. FIXED GLASS
	5"/10" THK. BRICK WORK

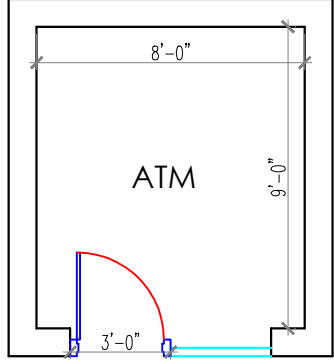

CANARA BANK SIRMATPUR

TOTAL CARPET AREA-840 SQFT
height-11'3"

Notes : ALL DIMENSIONS ARE TO BE CHECKED AND CO-RELATED WITH THE RELEVANT ARCHITECTURAL & STRUCTURAL DRAWINGS AND ANY AMBIGUITY SHALL BE IMMEDIATELY BROUGHT TO THE NOTICE OF THE ARCHITECTS BEFORE COMMENCEMENT OF THE WORK. THIS DRAWING IS THE PROPERTY OF ATTIK ARCHITECTS AND IS NOT TO BE COPIED OR USED WITHOUT THEIR PERMISSION.	Architects : ATTIK ARCHITECTS architect SITHLA ASTHAN ROAD, NEAR TILKAMANJHI THANA, BHAGALPUR, PH. NO. 7903821328 9430546484, 9899677289	Drawing Title:- SIRMATPUR BRANCH Internal	REVISIONS : <table border="1"> <thead> <tr> <th>Sl.No</th> <th>Date</th> <th>Reason</th> <th>Change</th> </tr> </thead> <tbody> <tr> <td> </td> <td> </td> <td> </td> <td> </td> </tr> <tr> <td> </td> <td> </td> <td> </td> <td> </td> </tr> <tr> <td> </td> <td> </td> <td> </td> <td> </td> </tr> </tbody> </table>	Sl.No	Date	Reason	Change													Date:- 24-06-2025 Scale:- NTS DRG. NO:-01	Checked by: AR.VIKASH KR. Dealt by: R 1	NORTH : R 1
	Sl.No	Date	Reason	Change																		
Consultants :	Client : CANARA BANK	Job Title :	ATTIK ARCHITECTS <small>This drawing/design is property of Attik architects. No part of this may be reproduced or implemented in any form without prior permission in writing from Architects. Any person doing so, shall be liable to criminal prosecution and civil claim for damages.</small>																			